

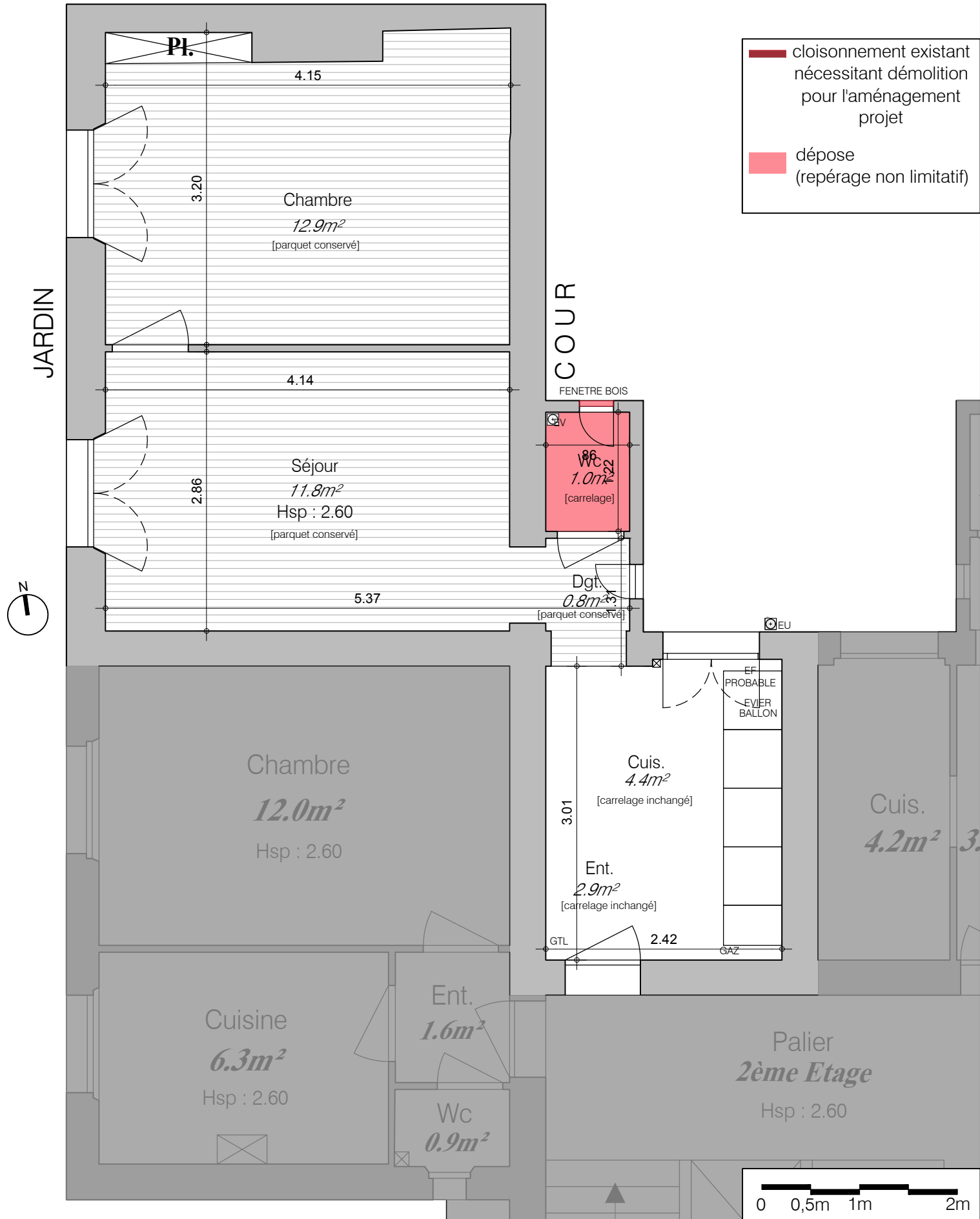

 cloisonnement existant
nécessitant démolition
pour l'aménagement
projet







 dépose
(repérage non limitatif)

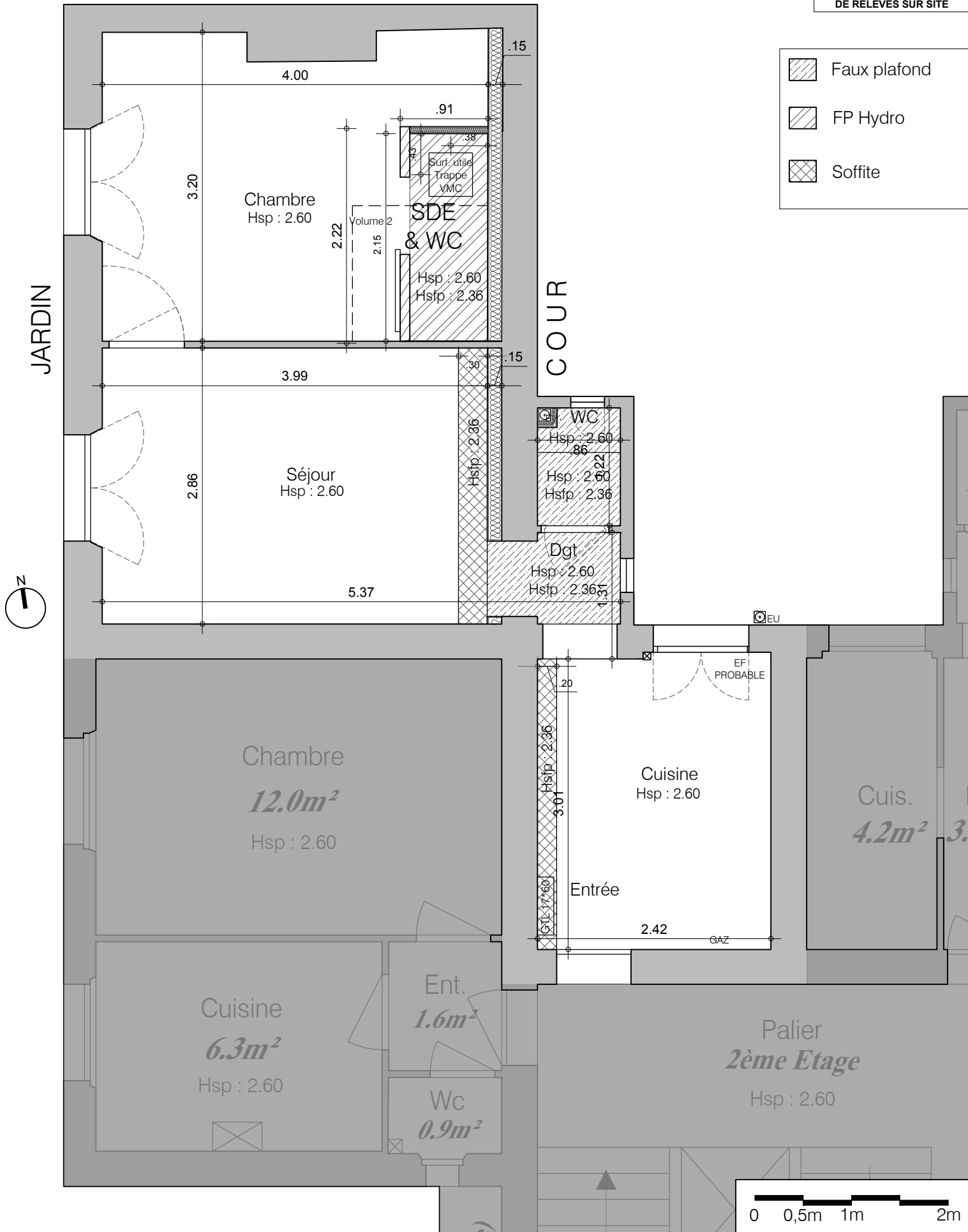

-  Faux plafond
-  FP Hydro
-  Soffite



R+1
T2 - Porte FG
600A0112
LEQUEUX AISSI
PROJET
OCCUPE

-  Contre-cloisons plâtre sur ossature métallique avec isolation R≥3,7
-  Cloisons en carreaux de plâtre hydrofuge
-  Cloisons en plaques de plâtre 72/48
-  Contre-cloisons en plaques de plâtre sur ossature métallique
-  Plaques de plâtre BA13 HYDRO
-  Cloisons existante conservée

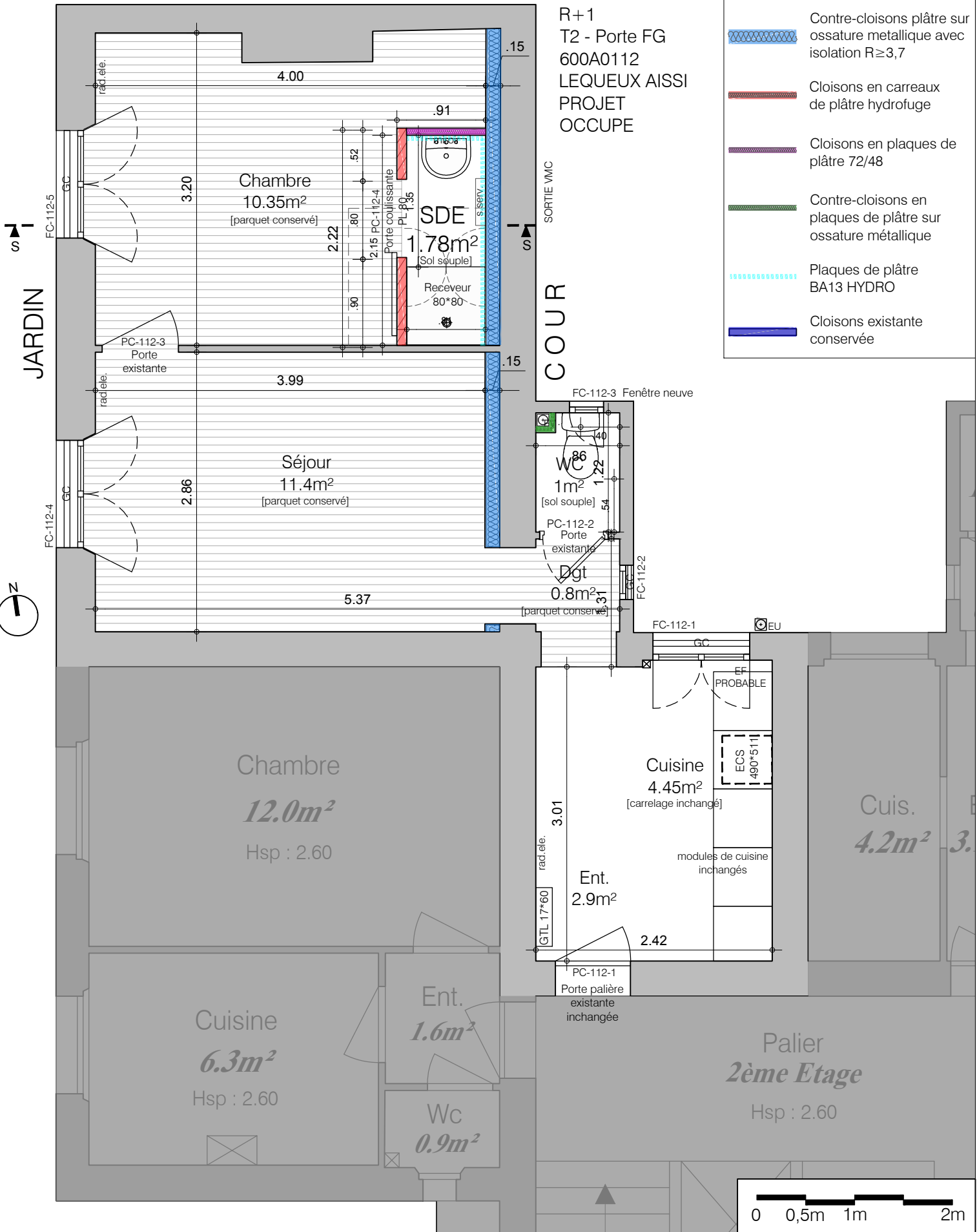

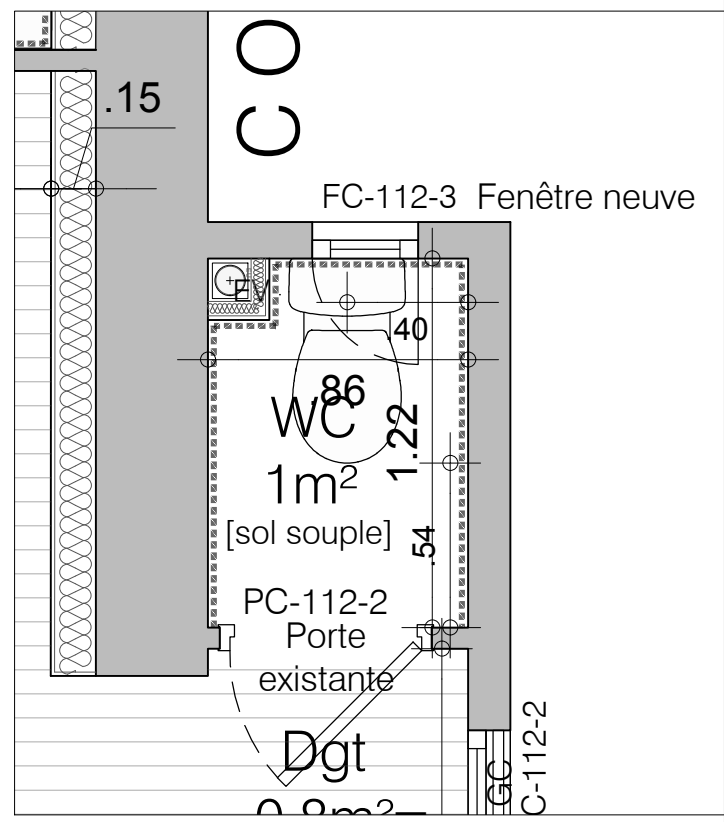
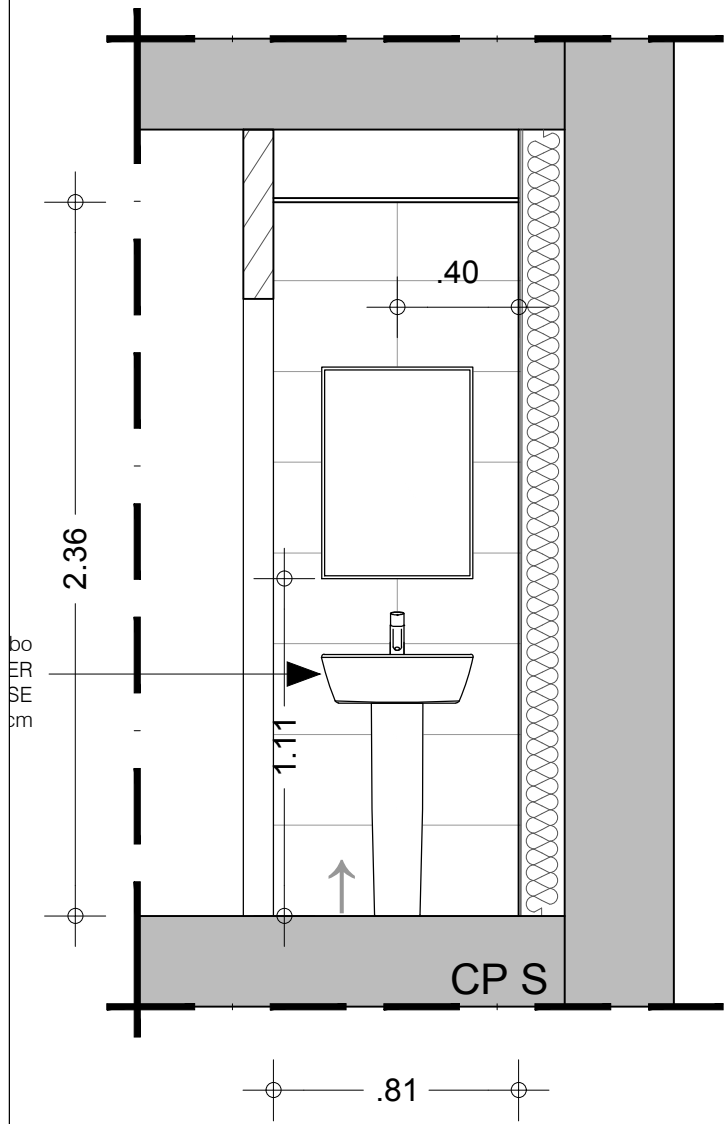
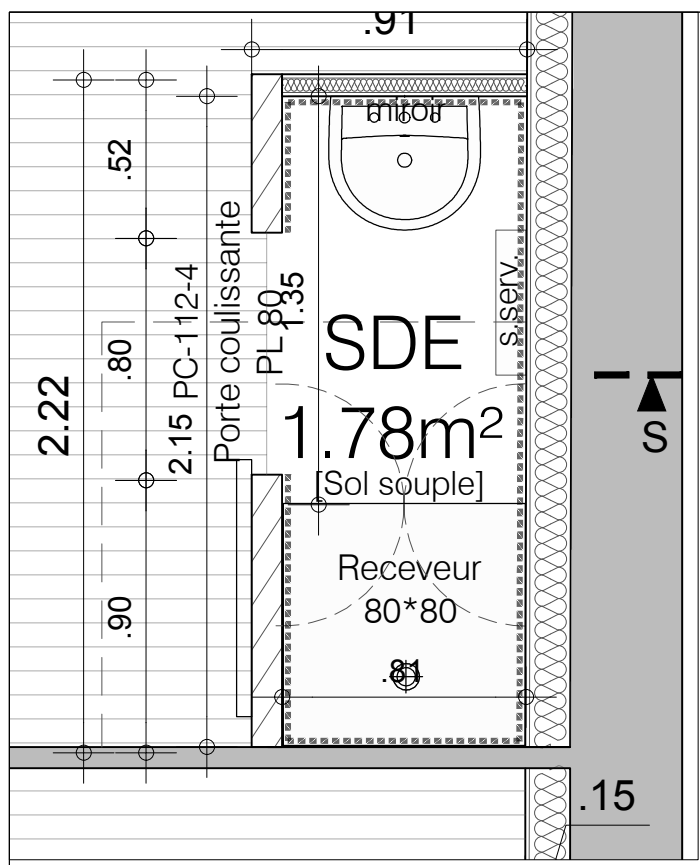

PLANS REALISE SUR LA
BASE DE PLANS DE
GEOMETRE

COTES COMMUNIQUEES A
TITRE INFORMATIF
DEVONT FAIRE L'OBJET
DE RELEVES SUR SITE

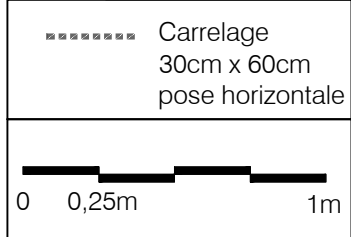



COUR

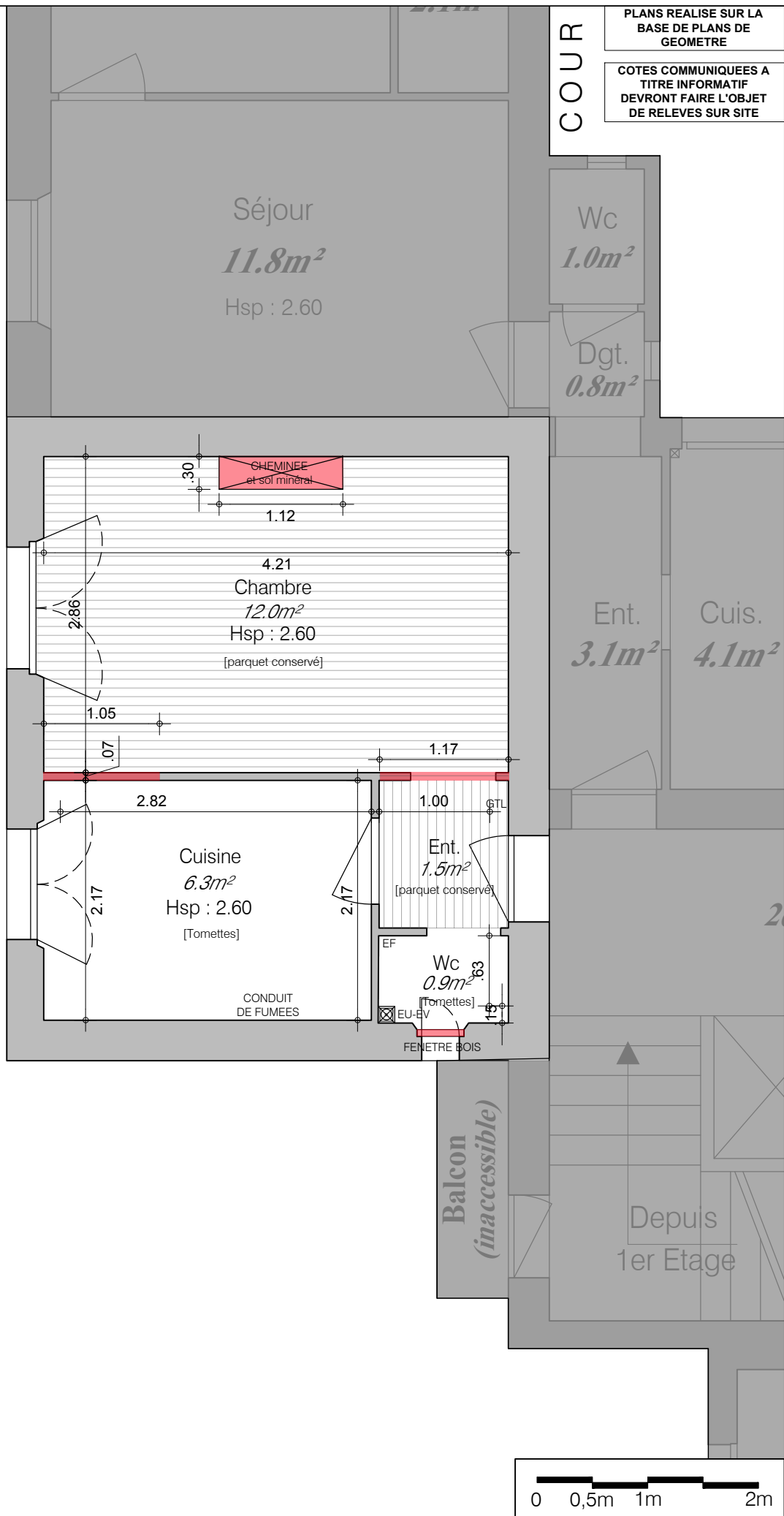

JARDIN



-  cloisonnement existant nécessitant démolition pour l'aménagement projet
-  dépose (repérage non limitatif)

COUR

Séjour
11.8m²
Hsp : 2.60

Wc
1.0m²
Dgt.
0.8m²



Evier inox à
encastrer sur PDI :
Type ECO860 Moderna
FC-221-2

JARDIN

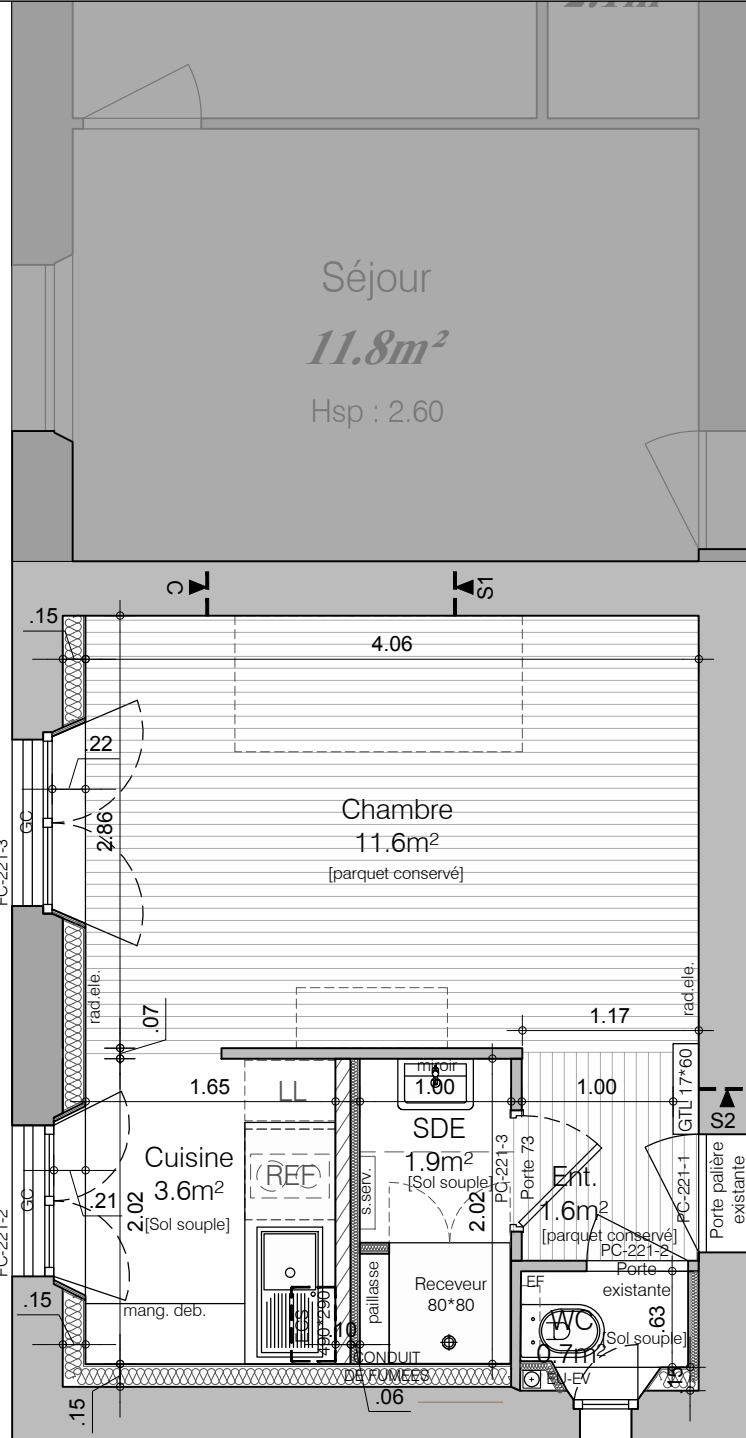

R+2
T1 - Porte G
600A0221
EX ALLAIN
PROJET

Balcon
(inaccessible)

Depuis
1er Etage

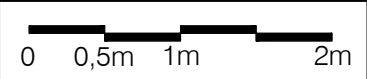

COUR

Séjour
11.8m²
Hsp : 2.60

Wc
1.0m²

Dgt.
0.8m²

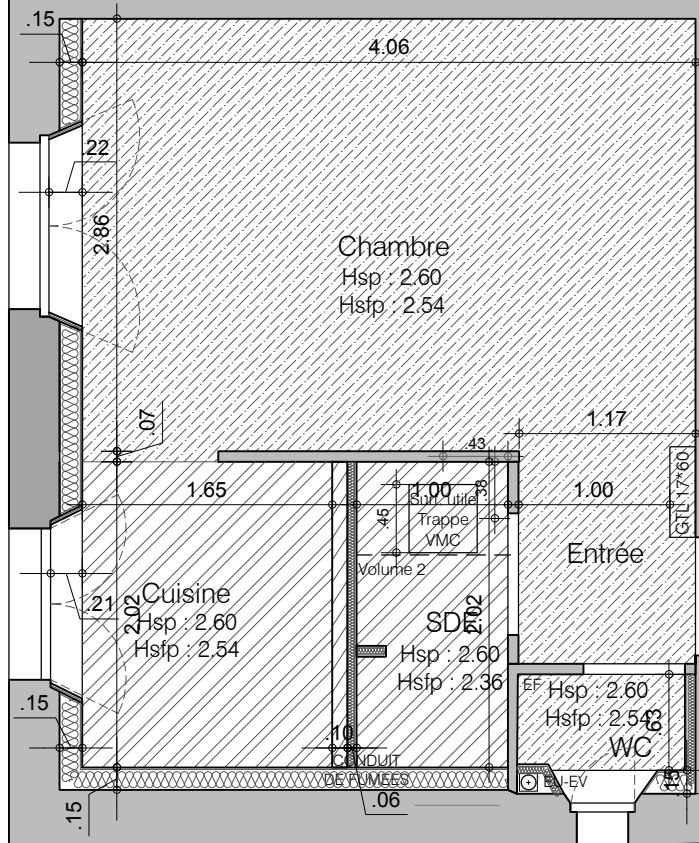

Ent.
3.1m²

Cuis.
4.1m²

JARDIN

Balcon
(inaccessible)

Depuis
1er Etage

- Faux plafond
- FP Hydro
- Soffite

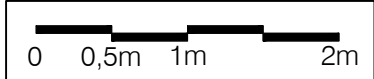

COUR

Séjour
11.8m²
Hsp : 2.60

Wc
1.0m²

Dgt.
0.8m²

Ent.
3.1m²

Cuis.
4.1m²







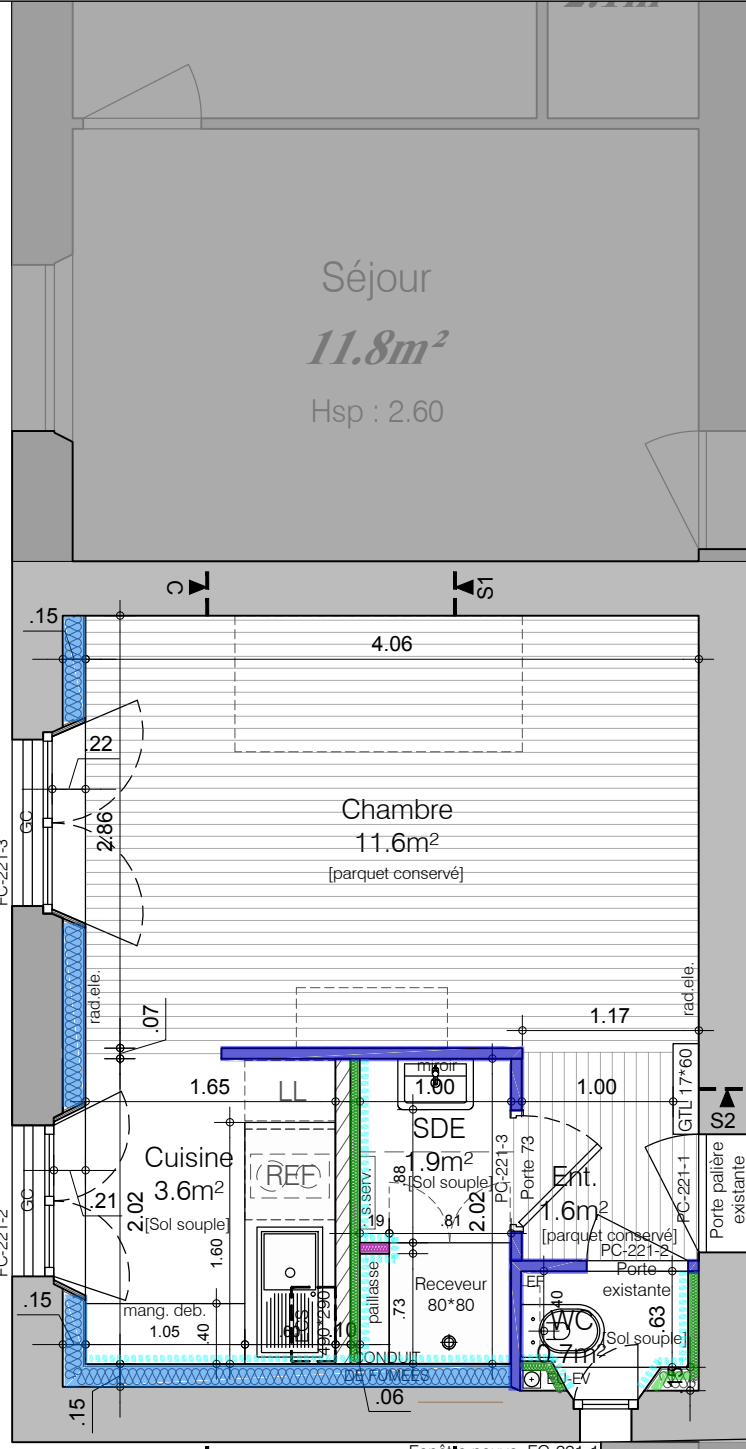

Evier inox à
encastrer sur PDI :
Type ECO860 Moderna
FC-221-2

JARDIN



R+2
T1 - Porte G
600A0221
EX ALLAIN
PROJET

-  Contre-cloisons plâtre sur ossature métallique avec isolation R≥3,7
-  Cloisons en carreaux de plâtre hydrofuge
-  Cloisons en plaques de plâtre 72/48
-  Contre-cloisons en plaques de plâtre sur ossature métallique
-  Plaques de plâtre BA13 HYDRO
-  Cloisons existante conservée

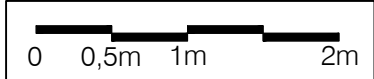

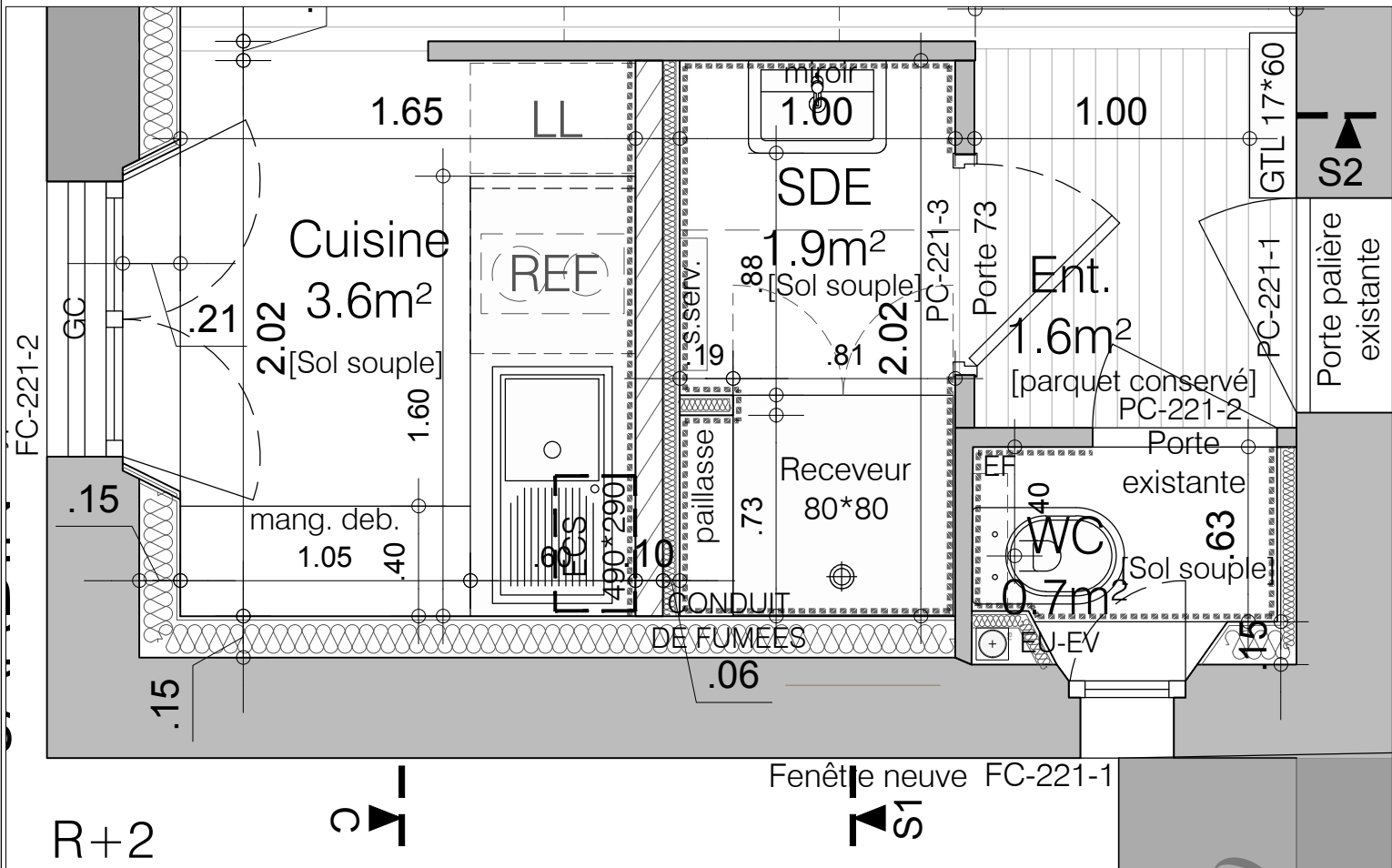

PLANS REALISE SUR LA
BASE DE PLANS DE
GEOMETRE

COTES COMMUNIQUEES A
TITRE INFORMATIF
DEVONT FAIRE L'OBJET
DE RELEVES SUR SITE

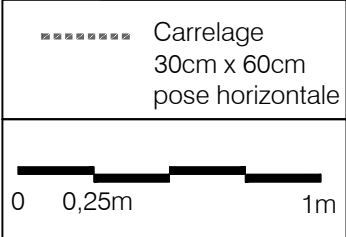

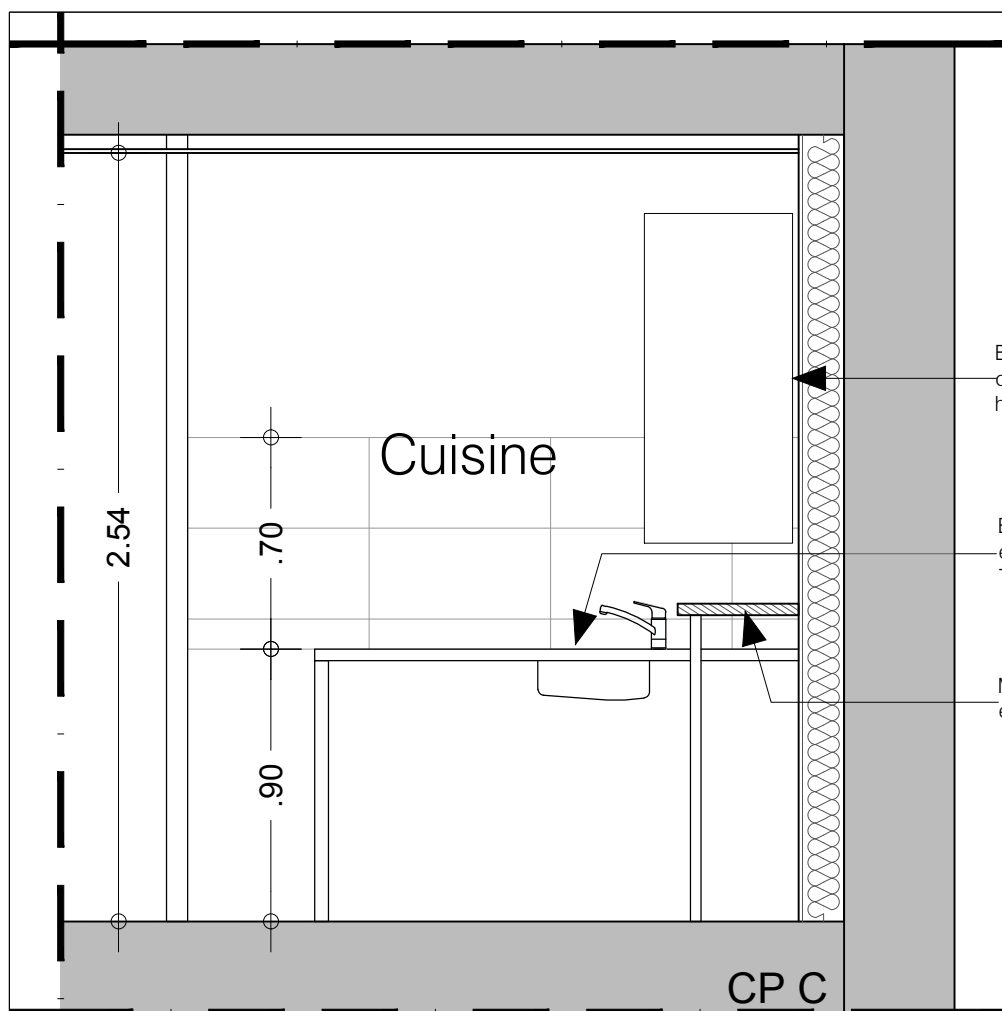
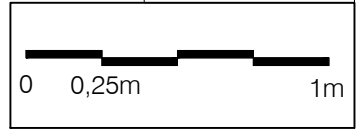

Ballon
d'Eau Chaude Sanitaire
h.1090*490*290

Evier inox à
encastrer sur PDT.
Type ECO860 Moderna

Mange-debout
ep.38mm

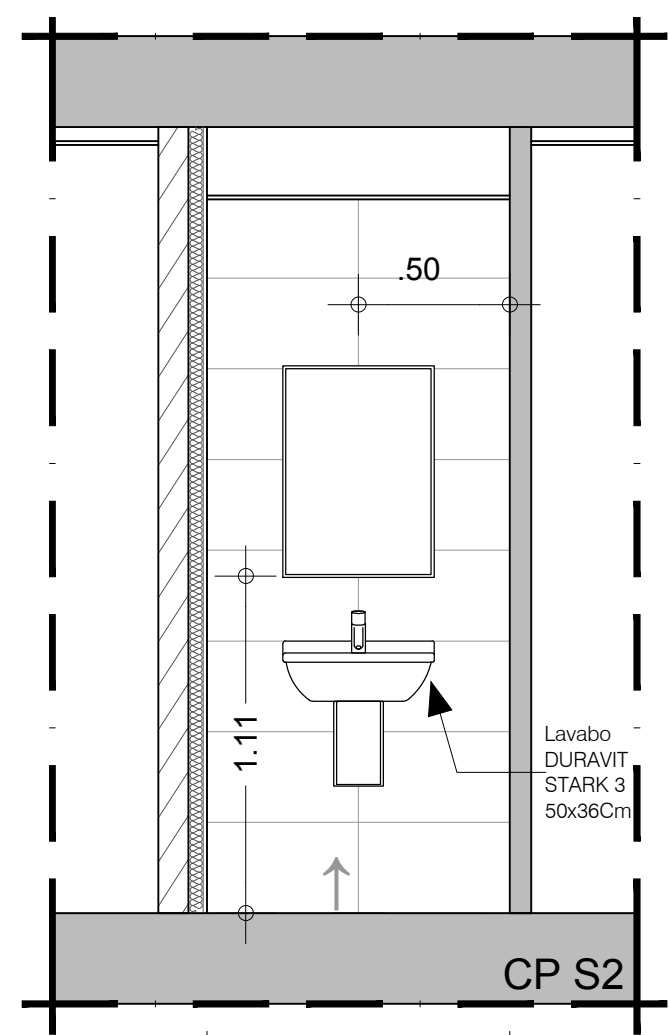
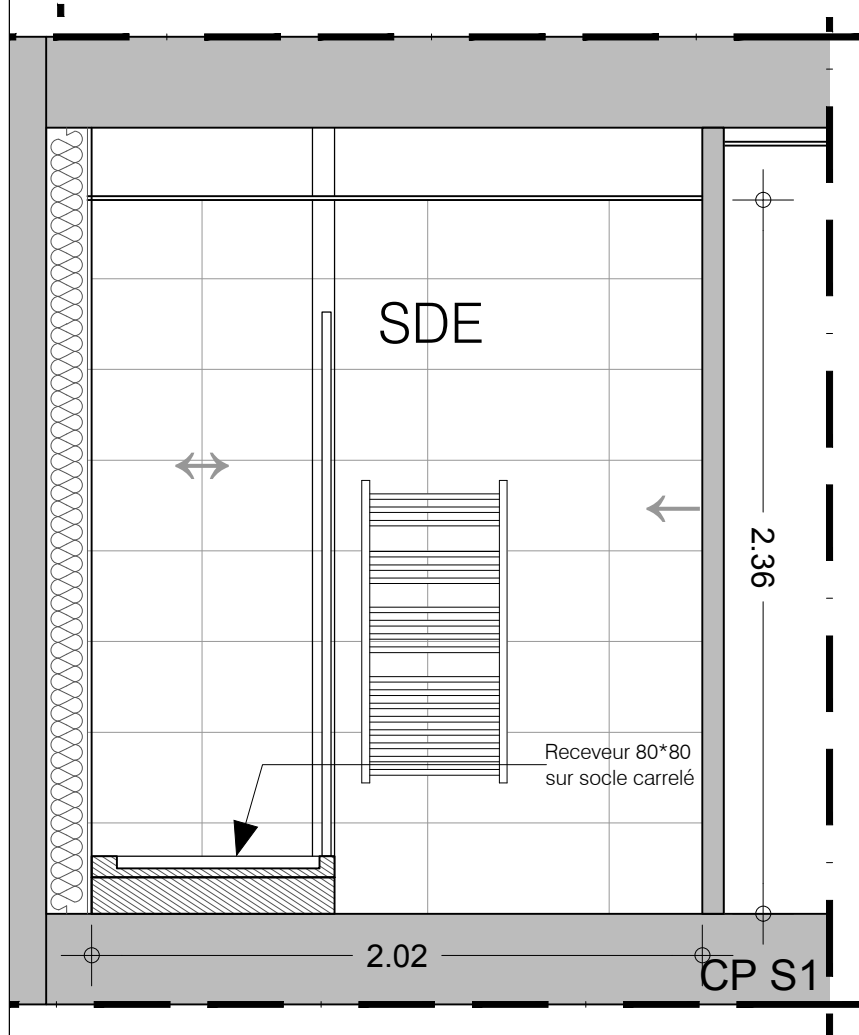



— cloisonnement existant nécessitant démolition pour l'aménagement projet

■ dépose (repérage non limitatif)

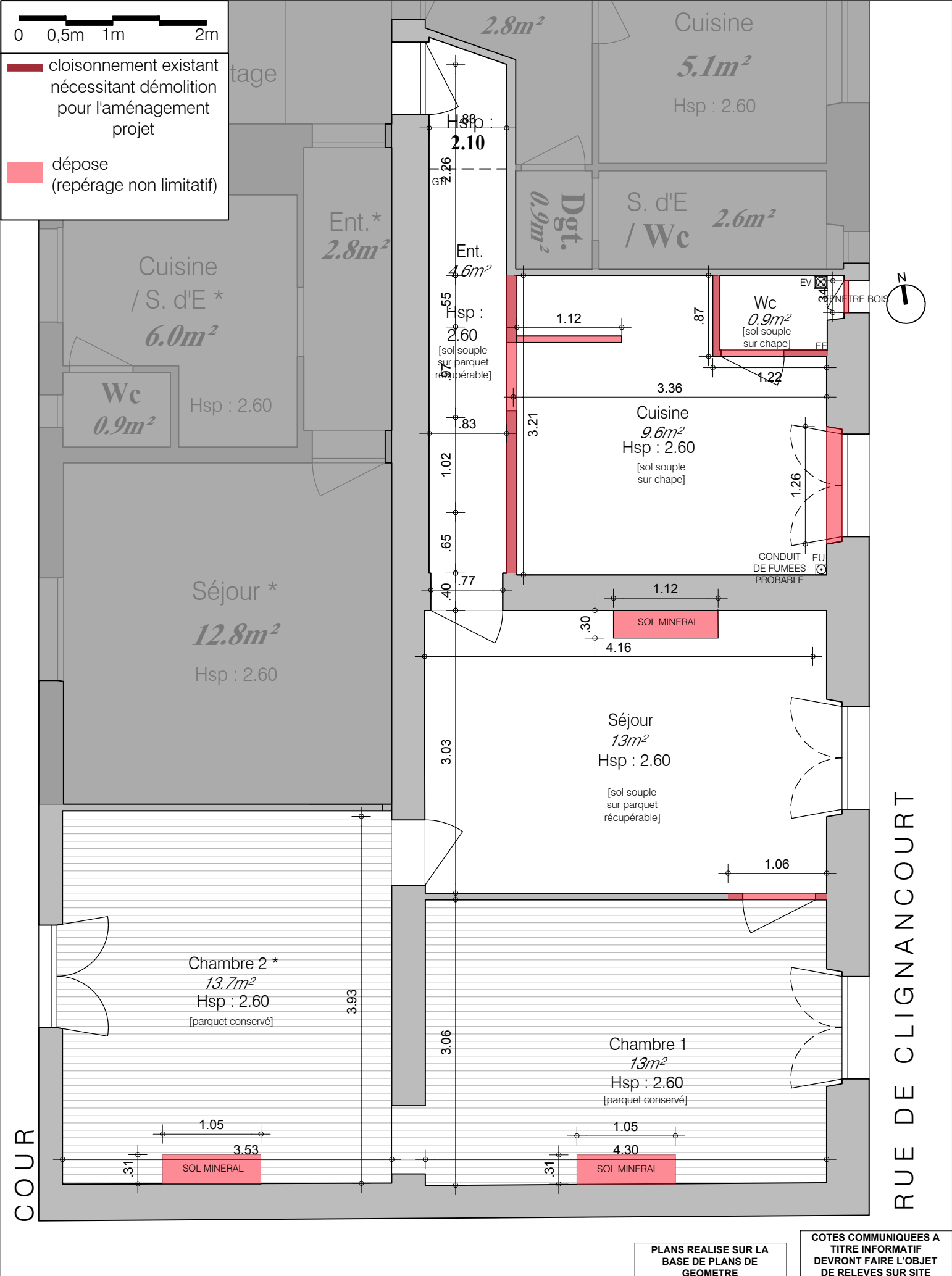

PLANS REALISE SUR LA BASE DE PLANS DE GEOMETRE

COTES COMMUNIQUEES A TITRE INFORMATIF DEVRONT FAIRE L'OBJET DE RELEVES SUR SITE



Etage 3ème Etage

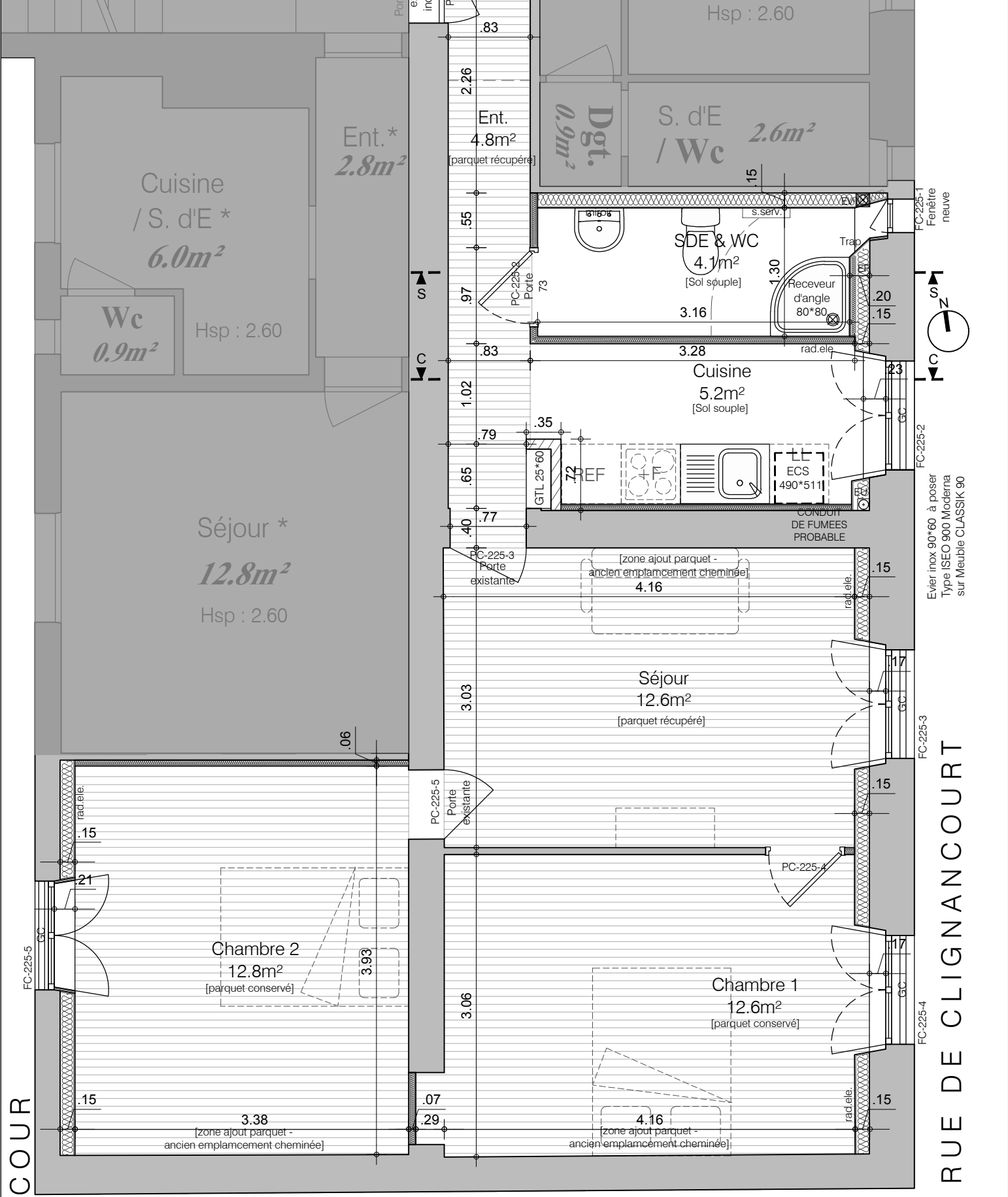

COUR

RUE DE CLIGNANCOURT

R+2 600A0225 EX FRIQUET - PROJET
T3 - Porte FD

PLANS REALISE SUR LA
BASE DE PLANS DE
GEOMETRE

COTES COMMUNIQUEES A
TITRE INFORMATIF
DEVONT FAIRE L'OBJET
DE RELEVES SUR SITE

RING STUDIO
ARCHITECTURE

LOGEMENTS SOC. PHILANTROPIQUE
77 rue de Clignancourt 75018 Paris
ringstudioarchitecture@gmail.com

NIVEAU R+2 - PLAN APPARTEMENT EX FRIQUET - N°600A0225

PLANS PROJET

ECHELLE : 1/50e A4 03.05.2022

PHASE DCE

Indice :



2ème Etage 3ème Etage

- Faux plafond
- FP Hydro
- Soffite

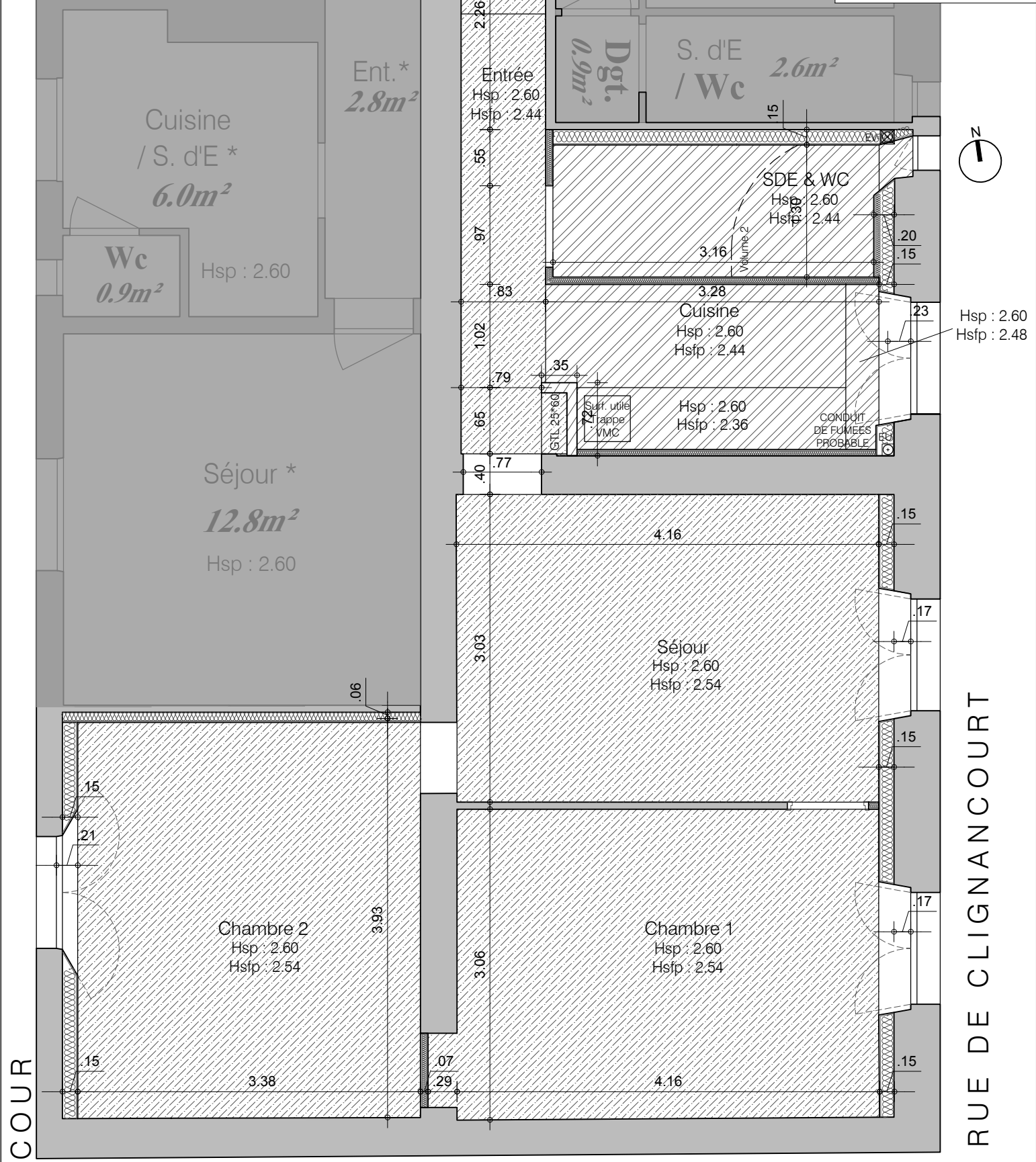

COUR

RUE DE CLIGNANCOURT

PLANS REALISE SUR LA
BASE DE PLANS DE
GEOMETRE

COTES COMMUNIQUEES A
TITRE INFORMATIF
DEVONT FAIRE L'OBJET
DE RELEVES SUR SITE



- Contre-cloisons plâtre sur ossature métallique avec isolation $R \geq 3,7$
- Cloisons en carreaux de plâtre hydrofuge
- Cloisons en plaques de plâtre 72/48
- Contre-cloisons en plaques de plâtre sur ossature métallique
- Plaques de plâtre BA13 HYDRO
- Cloisons existante conservée

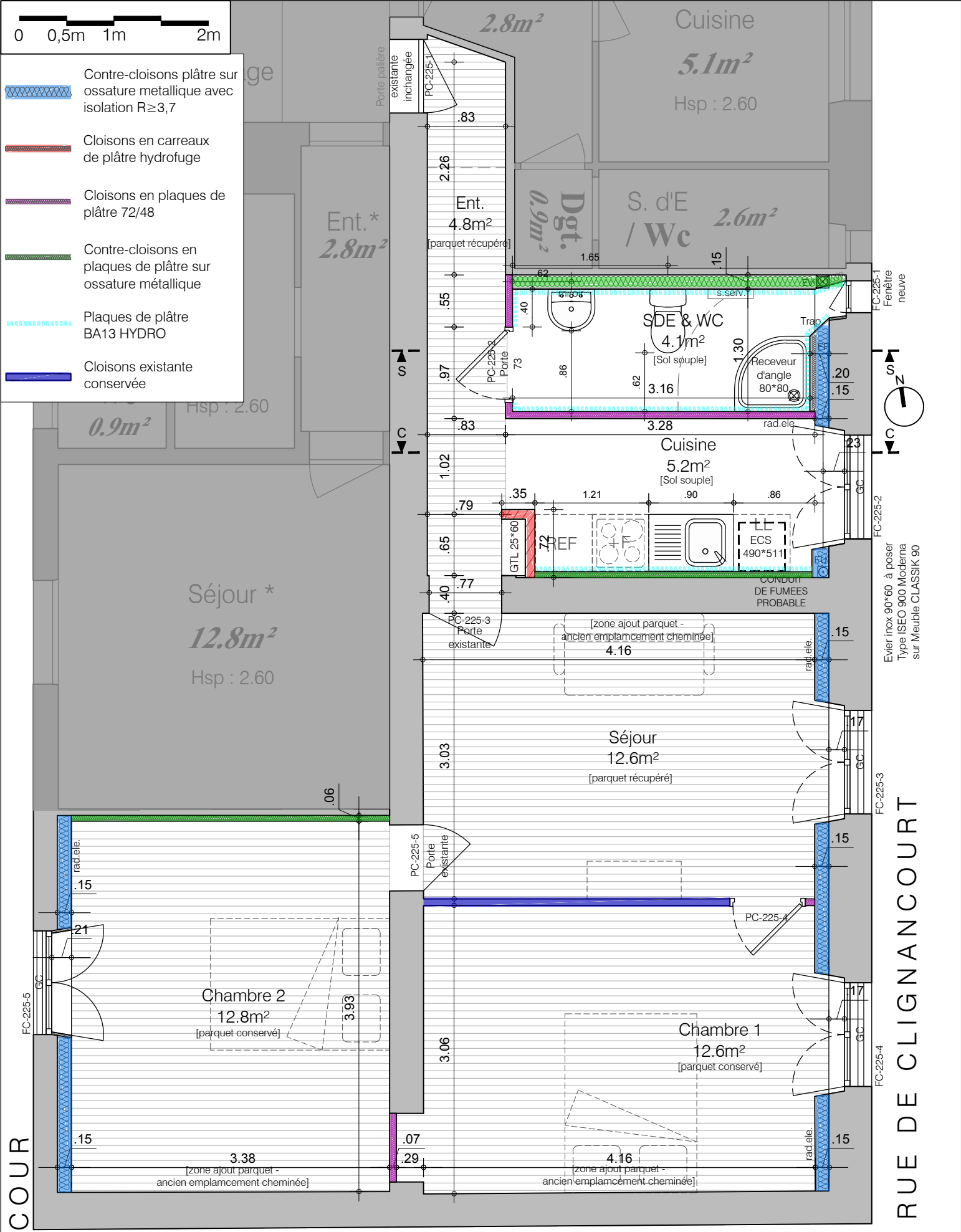

R+2 600A0225 EX FRIQUET - PROJET
T3 - Porte FD

PLANS REALISE SUR LA
BASE DE PLANS DE
GEOMETRE

COTES COMMUNIQUEES A
TITRE INFORMATIF
DEVONT FAIRE L'OBJET
DE RELEVES SUR SITE

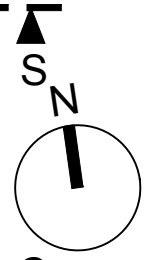
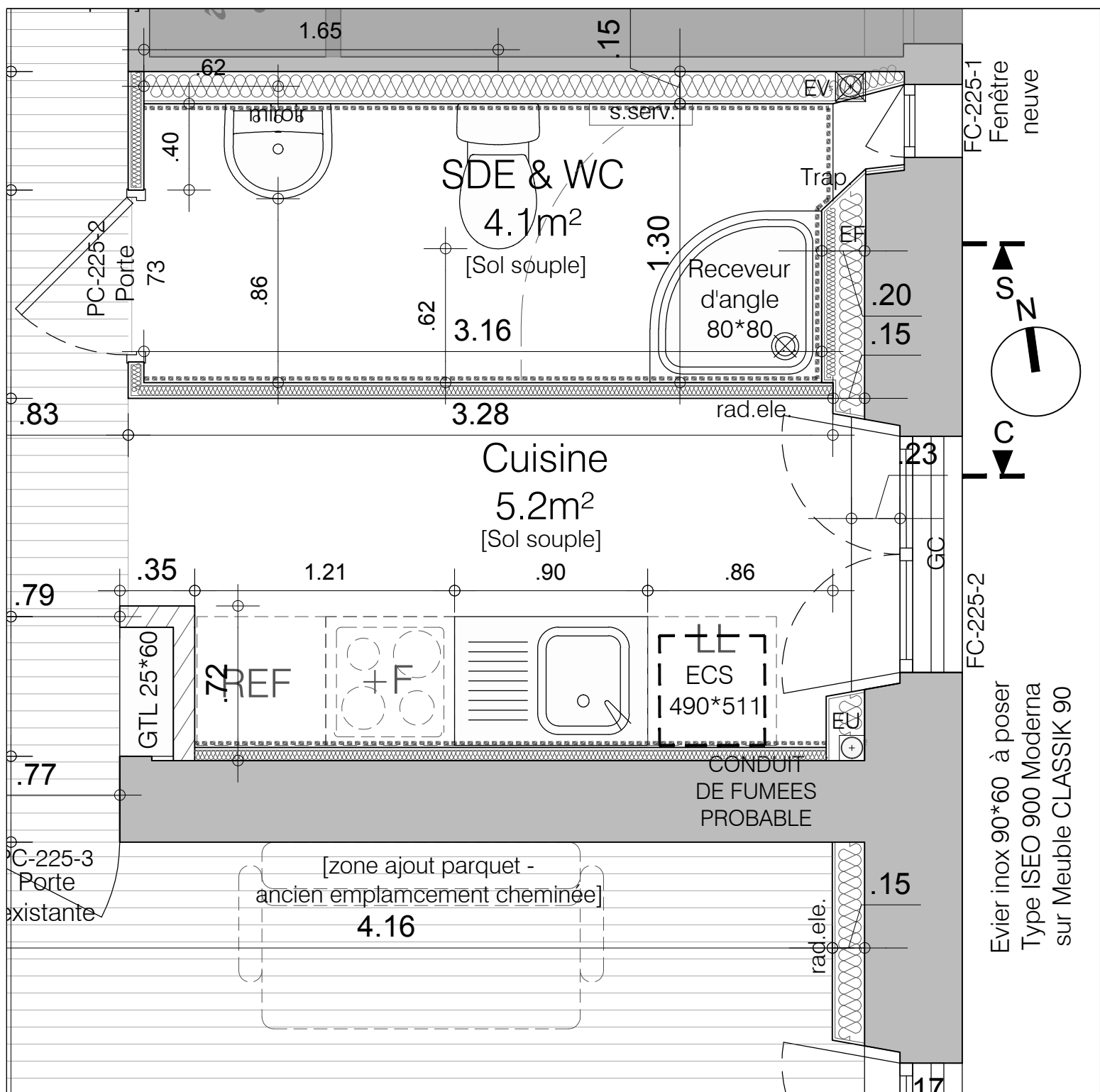

PLANS REALISE SUR LA BASE DE PLANS DE GEOMETRE

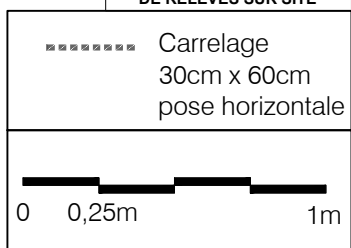

COTES COMMUNIQUEES A TITRE INFORMATIF DEVRONT FAIRE L'OBJET DE RELEVES SUR SITE

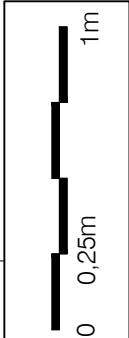
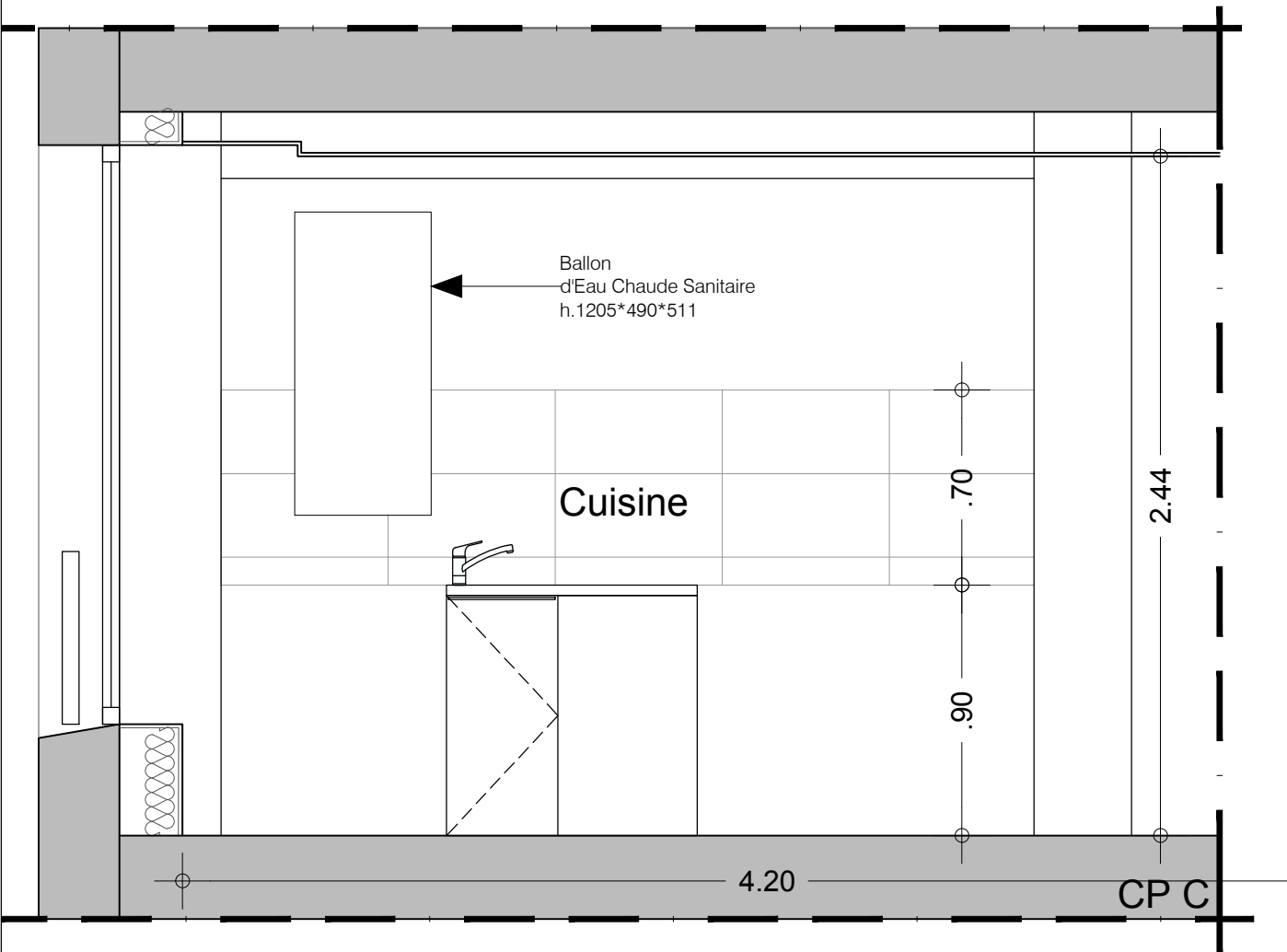
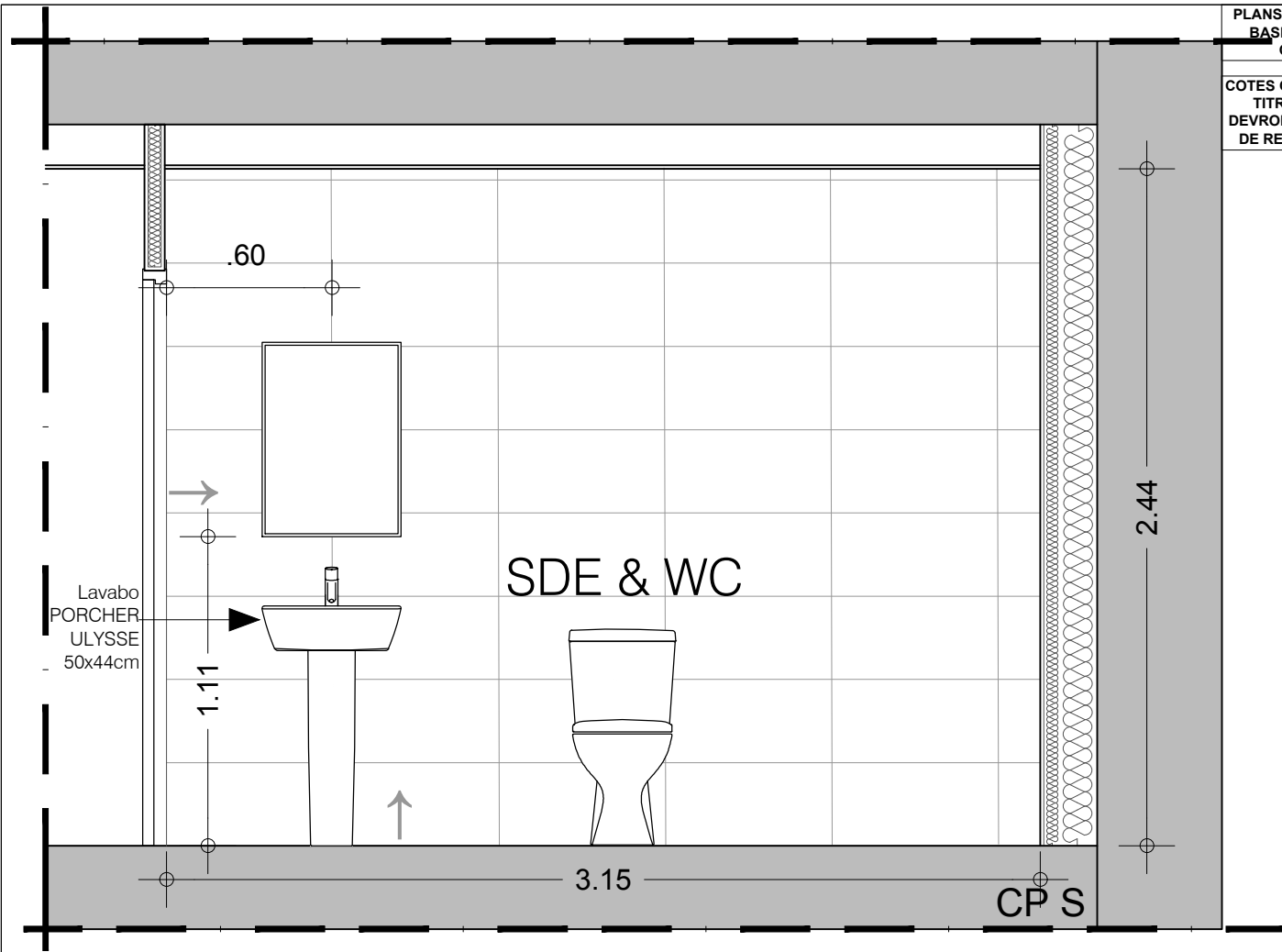

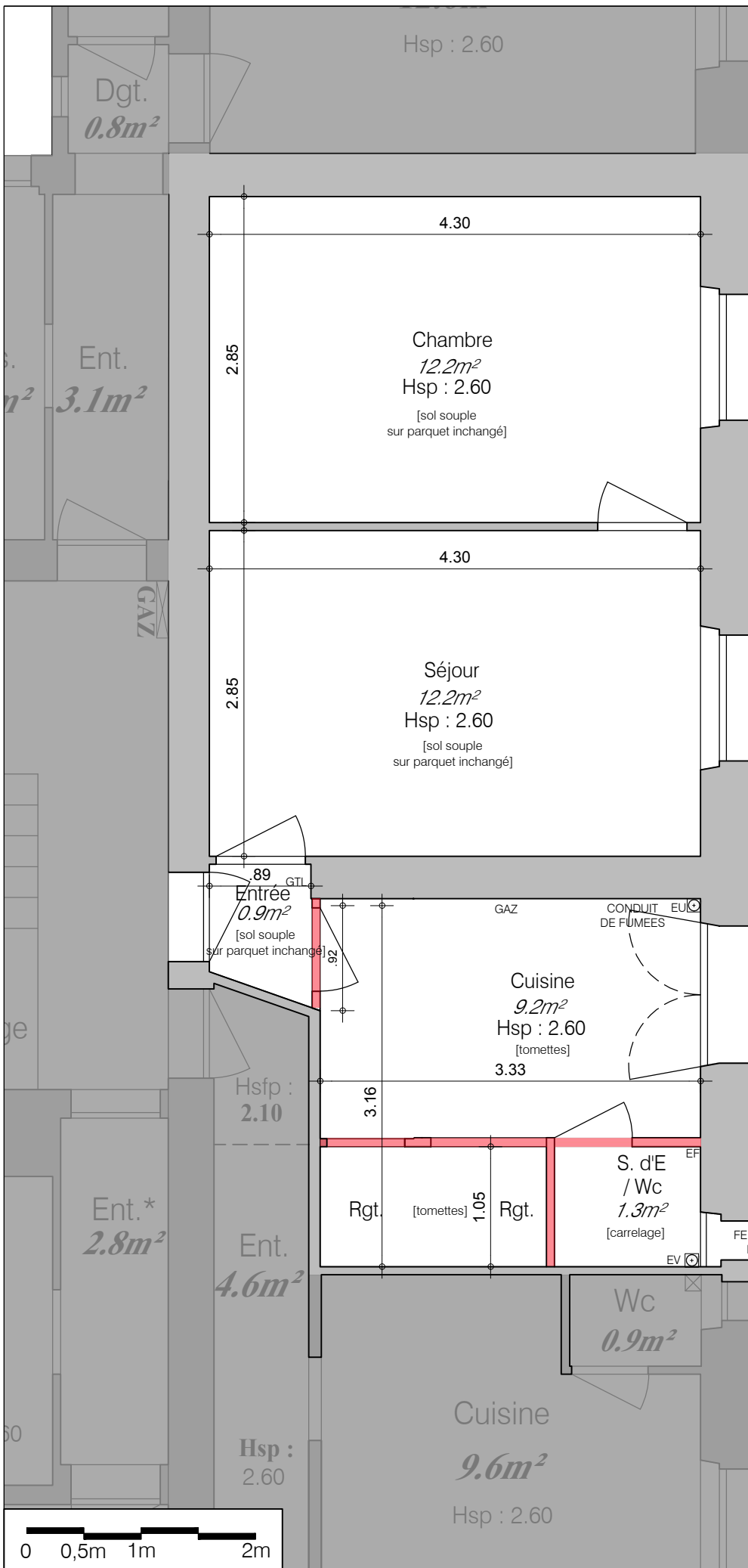



RUE DE CLIGNANCOURT

-  cloisonnement existant nécessitant démolition pour l'aménagement projet
-  dépose (repérage non limitatif)

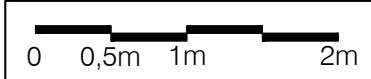

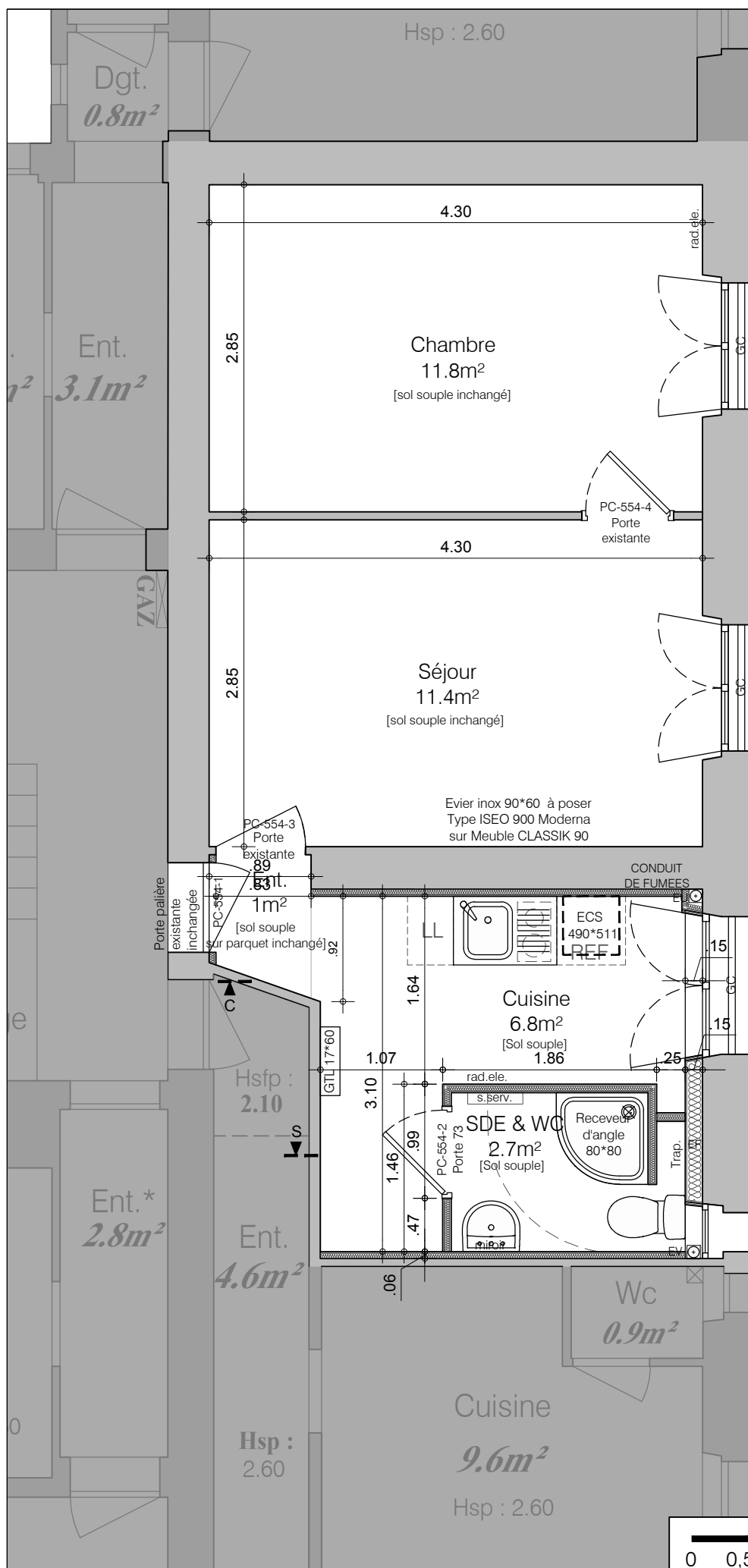



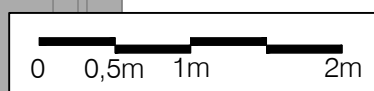

R+5
T2 - Porte FD
600A0554
AGIATO
PROJET
OCCUPE

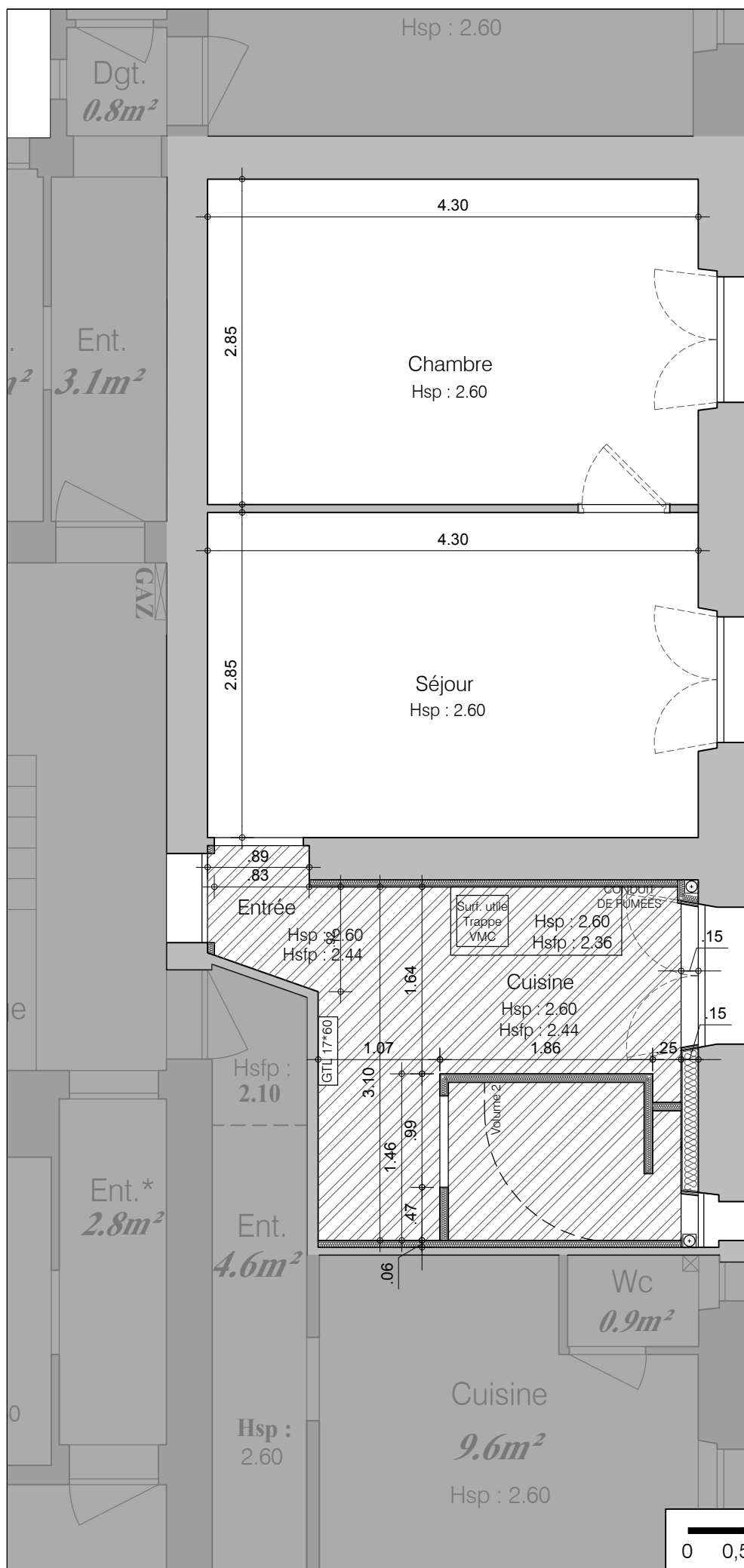
RUE DE CLIGNANCOURT



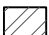

RUE DE CLIGNANCOURT

-  Faux plafond
-  FP Hydro
-  Soffite

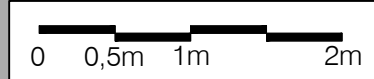





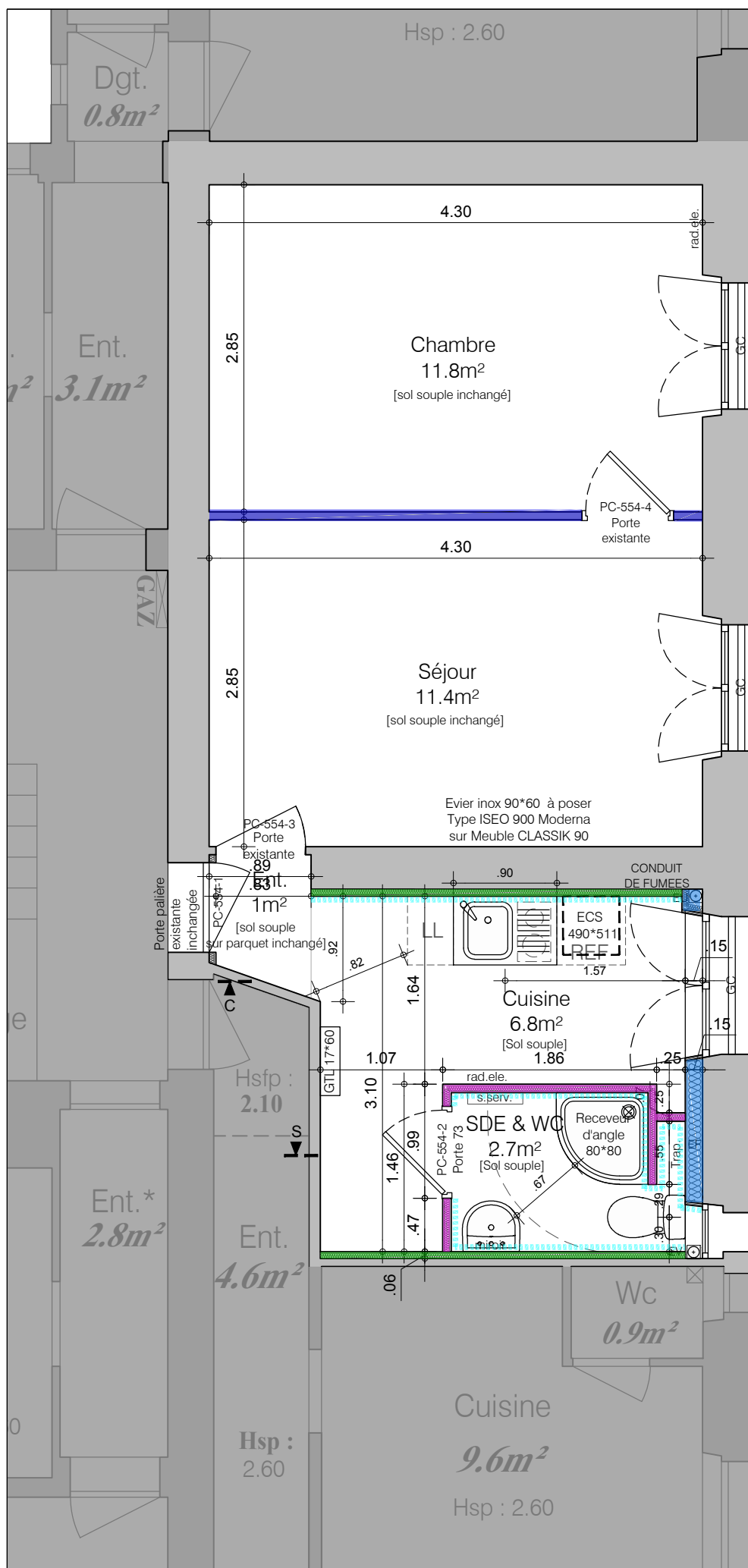

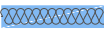

R+5
T2 - Porte FD
600A0554
AGIATO
PROJET
OCCUPE



RUE DE CLIGNANCOURT

-  Contre-cloisons plâtre sur ossature métallique avec isolation R≥3,7
-  Cloisons en carreaux de plâtre hydrofuge
-  Cloisons en plaques de plâtre 72/48
-  Contre-cloisons en plaques de plâtre sur ossature métallique
-  Plaques de plâtre BA13 HYDRO
-  Cloisons existante conservée

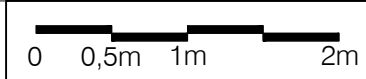

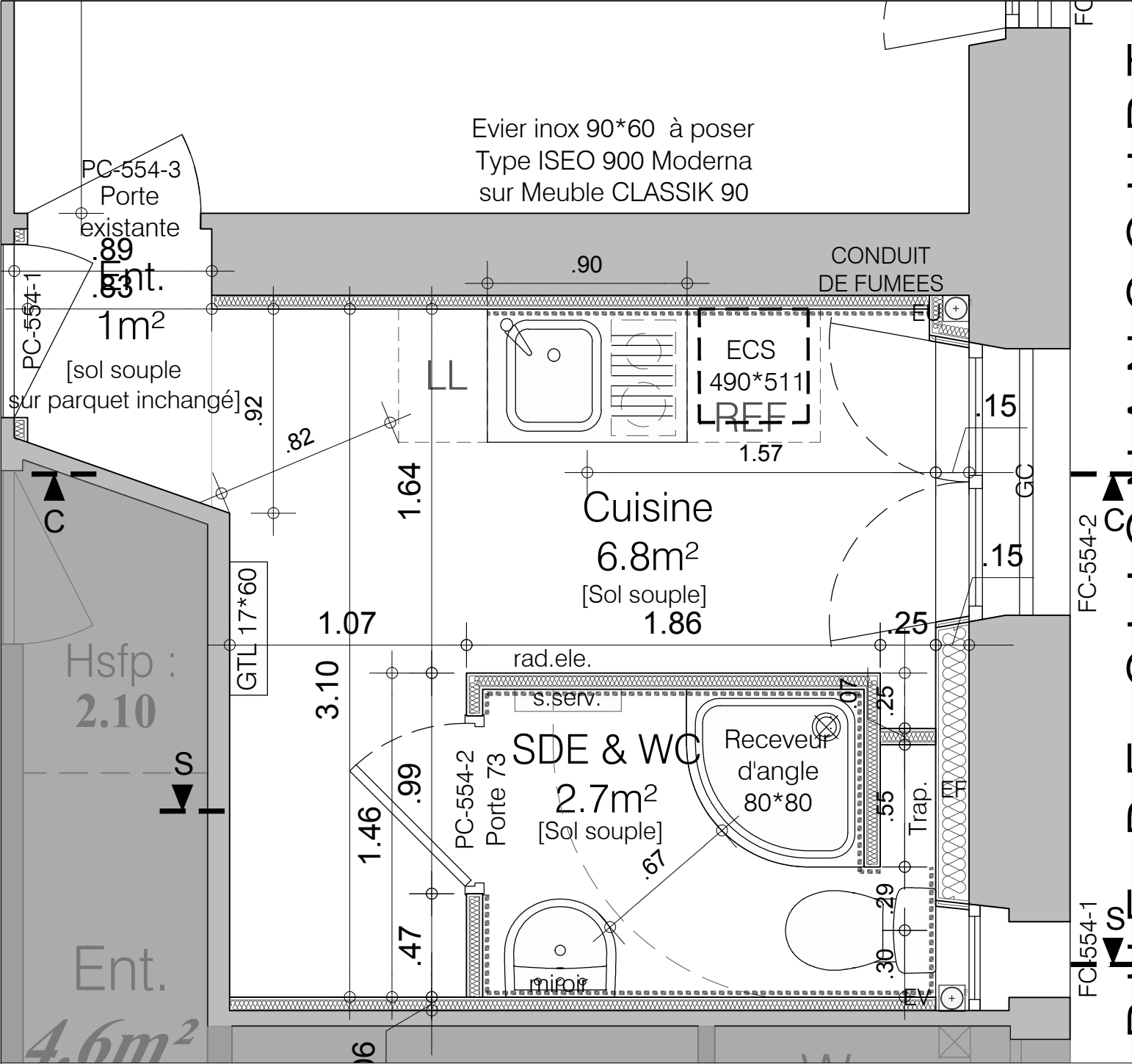

PLANS REALISE SUR LA
BASE DE PLANS DE
GEOMETRE

COTES COMMUNIQUEES A
TITRE INFORMATIF
DEVONT FAIRE L'OBJET
DE RELEVES SUR SITE

Carrelage
30cm x 60cm
pose horizontale

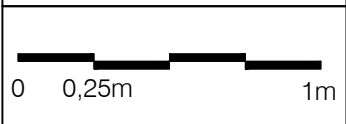

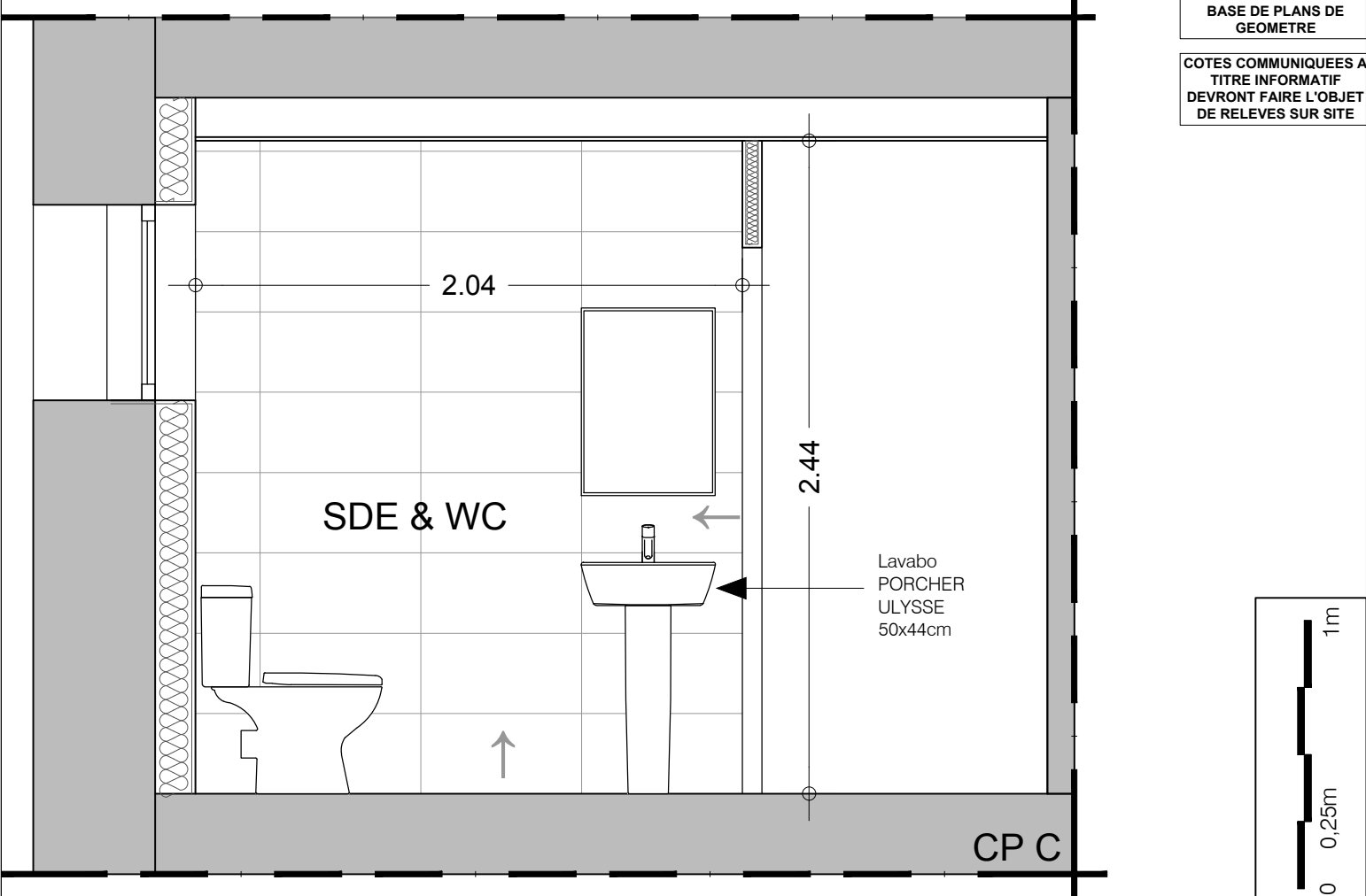
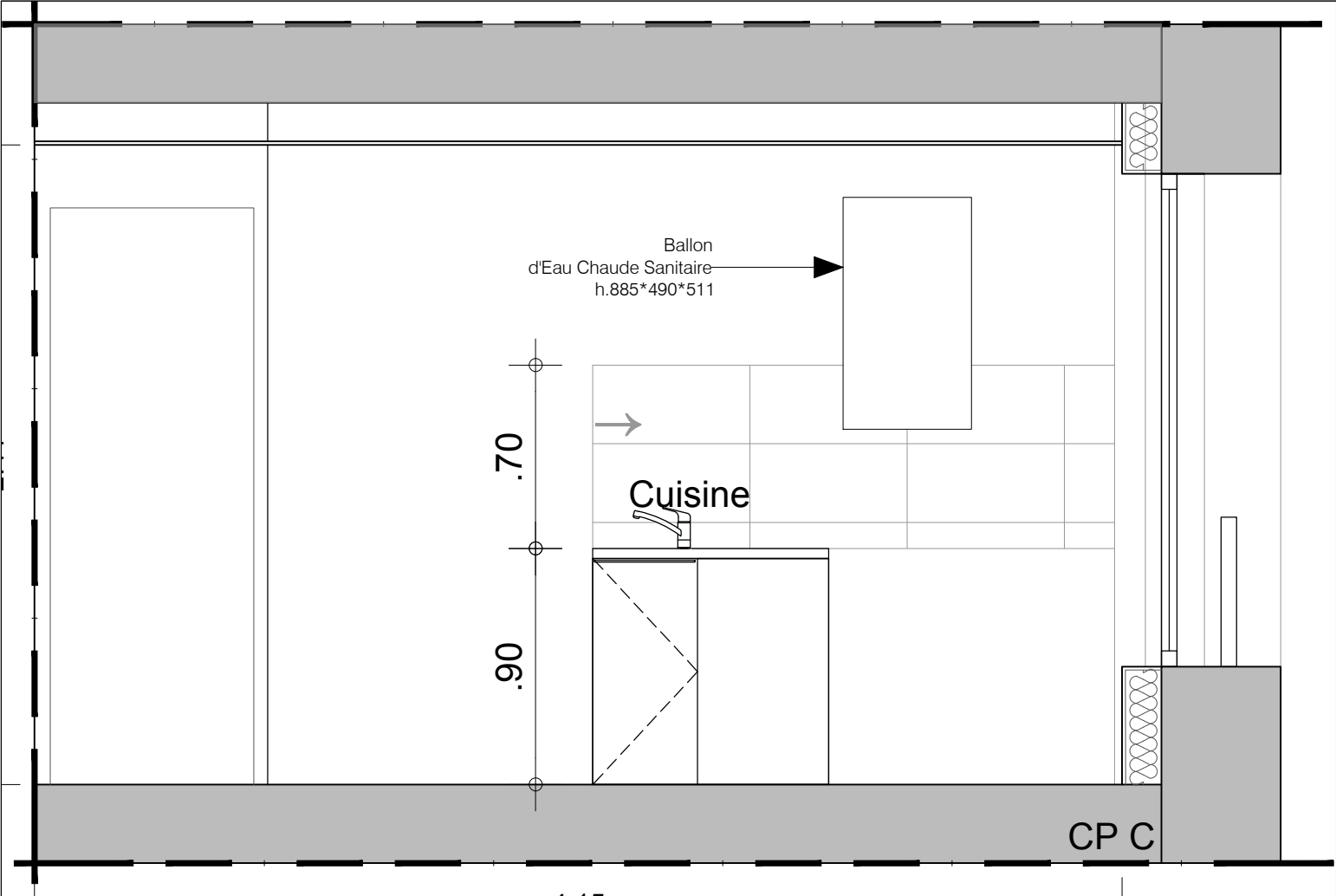

PLANS REALISE SUR LA
BASE DE PLANS DE
GEOMETRE

COTES COMMUNIQUEES A
TITRE INFORMATIF
DEVONT FAIRE L'OBJET
DE RELEVES SUR SITE

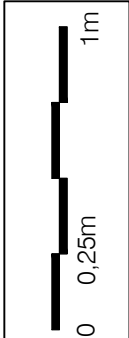

PLANS REALISE SUR LA
BASE DE PLANS DE
GEOMETRE

COTES COMMUNIQUEES A
TITRE INFORMATIF
DEVRONT FAIRE L'OBJET
DE RELEVES SUR SITE

Balcoi
(inaccessi)

Depuis
1er Etage

Vers
3ème Etage

Entrée
2.8m²

Hsfp :
2.10

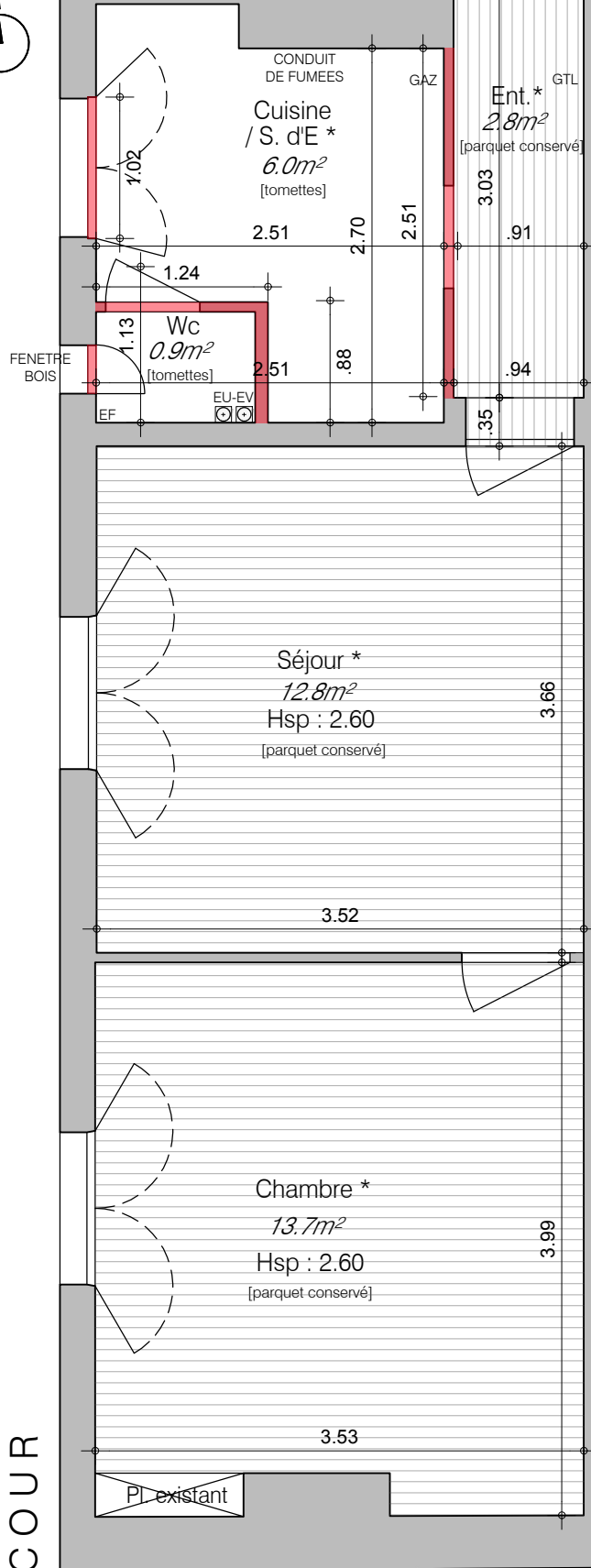

Ent.
4.6m²

Hsp :
2.60

Séjour *
12.8m²
Hsp : 2.60
[parquet conservé]

Chambre *
13.7m²
Hsp : 2.60
[parquet conservé]

COUR

■ cloisonnement existant
nécessitant démolition
pour l'aménagement
projet

■ dépose
(repérage non limitatif)

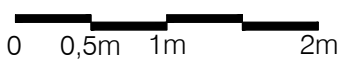

PLANS REALISE SUR LA
BASE DE PLANS DE
GEOMETRE

COTES COMMUNIQUEES A
TITRE INFORMATIF
DEVRONT FAIRE L'OBJET
DE RELEVES SUR SITE

Balco
(inaccessi

Depuis
1er Etage

Vers
3ème Etage

Entrée
2.8m²

Hsfp :
2.10

Ent.
4.6m²

Hsp :
2.60

R+5
T2 - Porte D
600A0556
POUILLARD
PROJET
OCCUPE

Evier inox 90*60 à poser
Type ISEO 900 Moderna
sur Meuble CLASSIK 90

FC-556-1

FC-556-2

FC-556-3

FC-556-4

COUR

Pl existant

rad.ele.

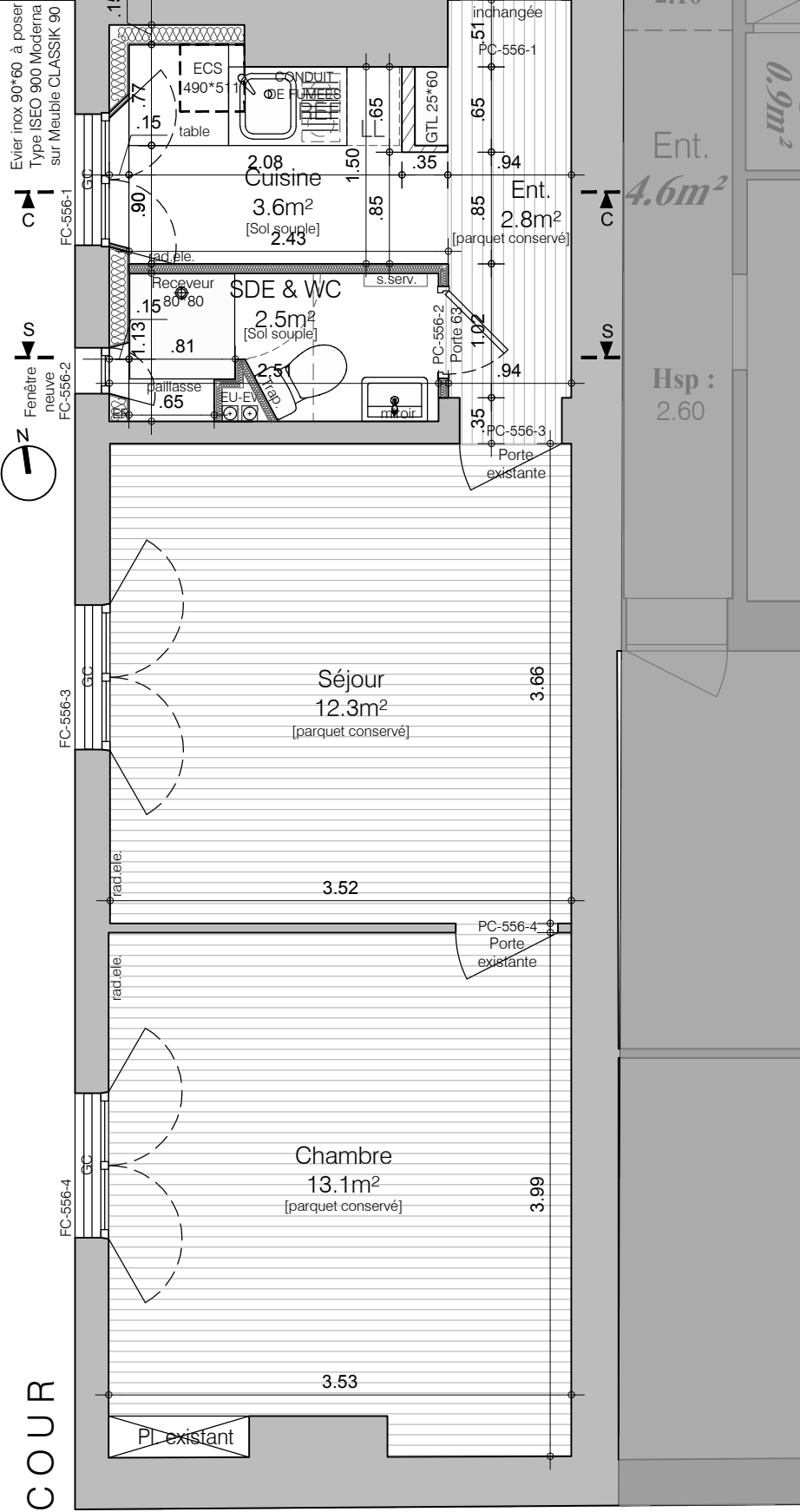

PLANS REALISE SUR LA
BASE DE PLANS DE
GEOMETRE

COTES COMMUNIQUEES A
TITRE INFORMATIF
DEVRONT FAIRE L'OBJET
DE RELEVES SUR SITE

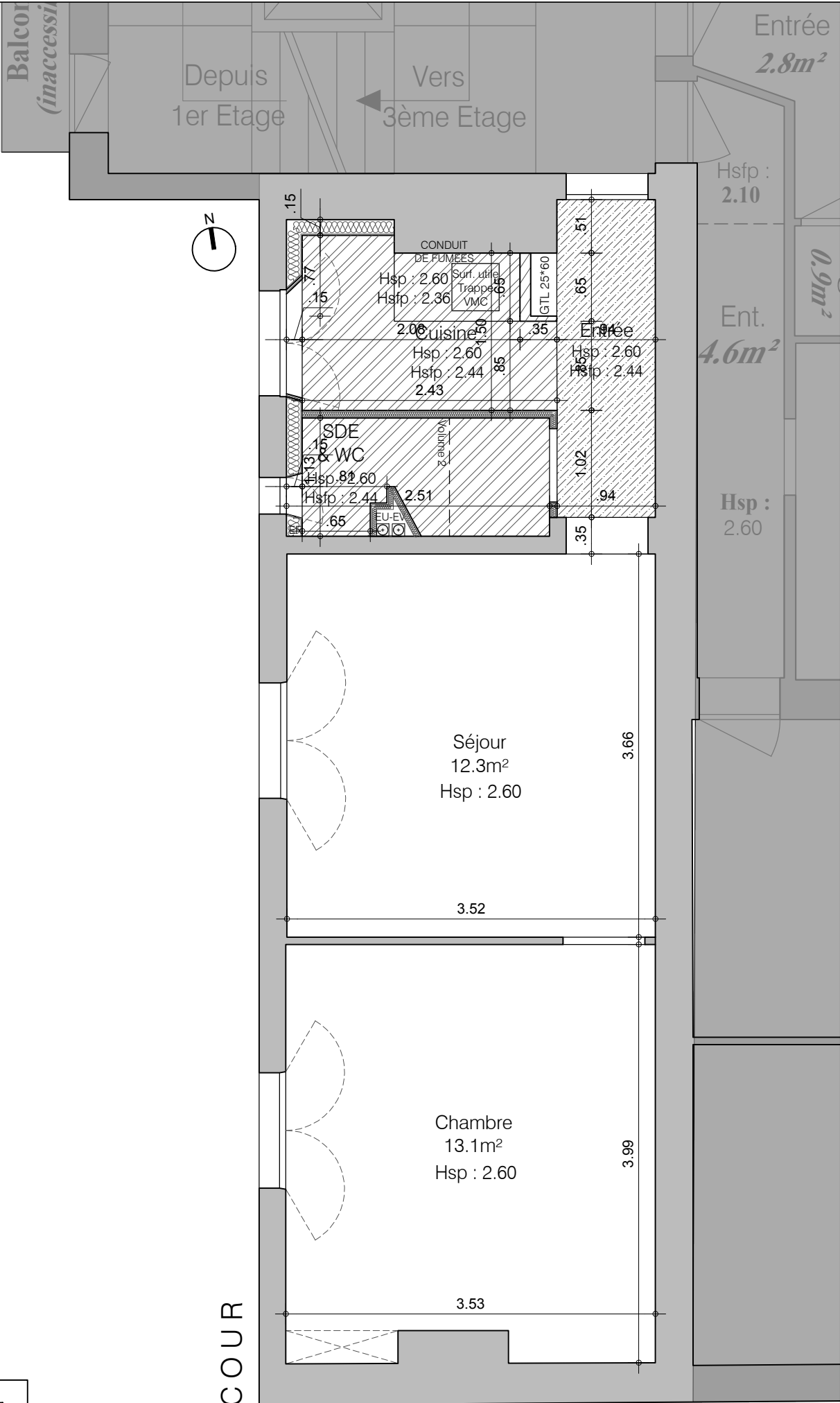

Faux plafond

FP Hydro

Soffite

0 0,5m 1m 2m

LOGEMENTS SOC. PHILANTROPIQUE

77 rue de Clignancourt 75018 Paris
ringstudioarchitecture@gmail.com

NIVEAU R+5 - PLAN APPARTEMENT POUILLARD - N°600A0556
PLANS DE REPERAGE PLAFOND

ECHELLE : 1/50e A4 03.05.2022

PHASE DCE

Indice :

R+5
T2 - Porte D
600A0556
POUILLARD
PROJET
OCCUPE

Evier inox 90°*60 à poser
Type ISEO 900 Moderna
sur Meuble CLASSIK 90

Fenêtre
neuve
FC-556-2



- Contre-cloisons plâtre sur ossature métallique avec isolation $R \geq 3,7$
- Cloisons en carreaux de plâtre hydrofuge
- Cloisons en plaques de plâtre 72/48
- Contre-cloisons en plaques de plâtre sur ossature métallique
- Plaques de plâtre BA13 HYDRO
- Cloisons existante conservée

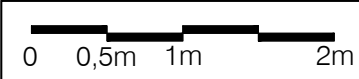

COUR

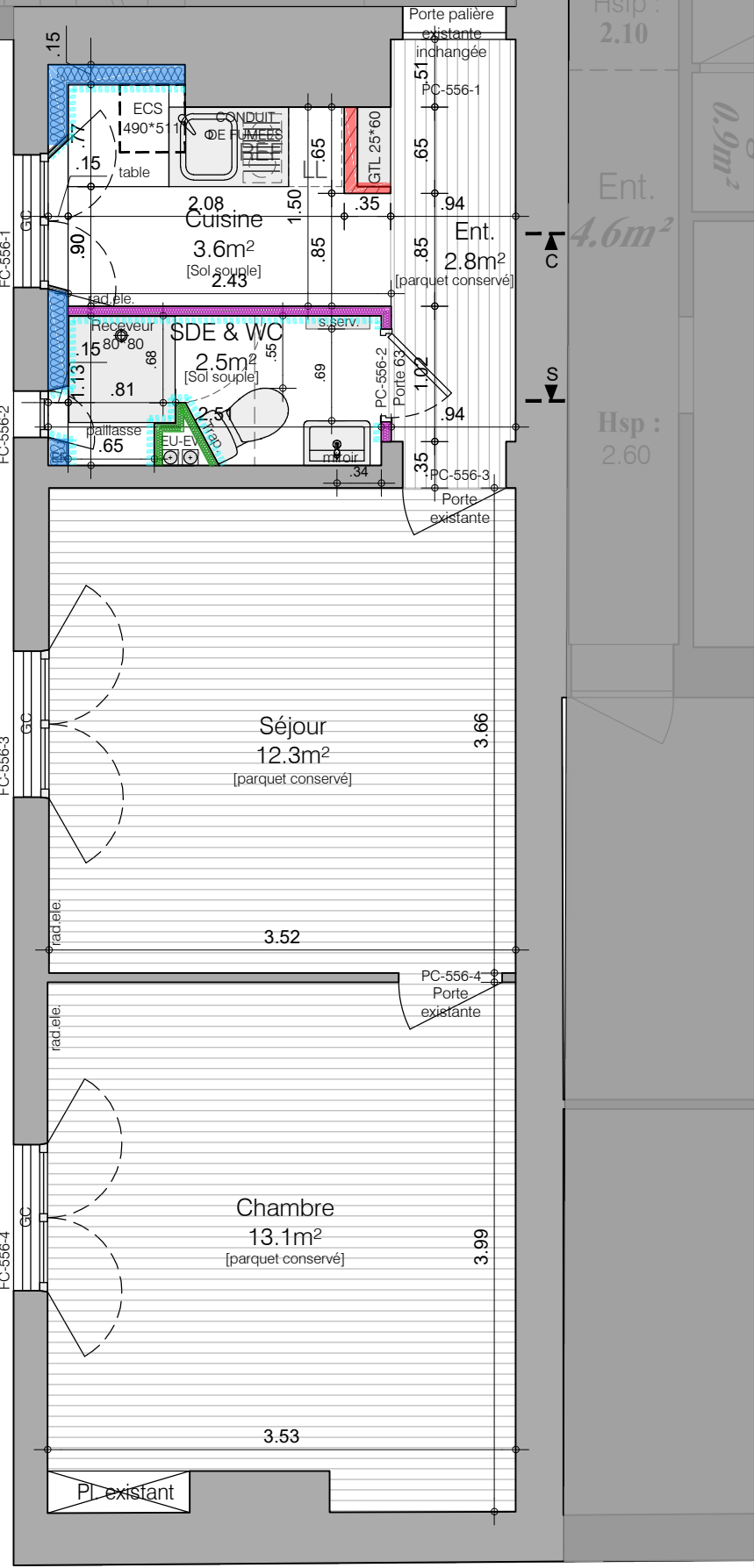

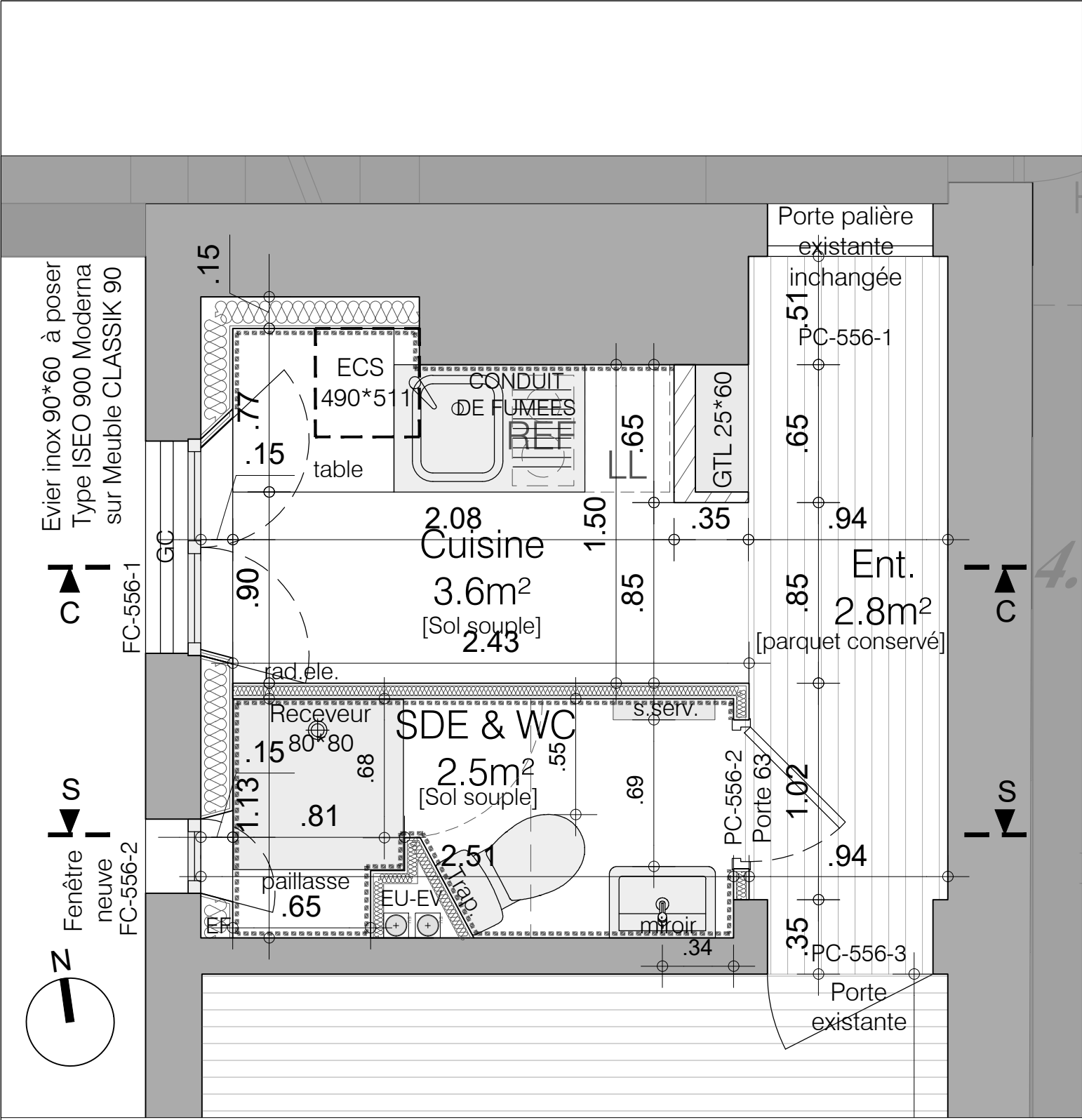

Evier inox 90*60 à poser
Type ISEO 900 Moderna
sur Meuble CLASSIK 90



FC-556-1

Fenêtre
neuve
FC-556-2

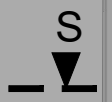
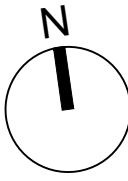

PLANS REALISE SUR LA
BASE DE PLANS DE
GEOMETRE

COTES COMMUNIQUEES A
TITRE INFORMATIF
DEVONT FAIRE L'OBJET
DE RELEVES SUR SITE

Carrelage
30cm x 60cm
pose horizontale

